

YARD FOR LEASE

WILLOWS ROAD NE SECURED, PAVED & LIT STORAGE LOT

12633 WILLOWS RD NE, KIRKLAND, WA 98034

±28K-57,146 SF [0.65-1.31 Acres]

Divisible to Half the Site



RARE CLOSE-IN LAYDOWN STORAGE LOT

- ±57,146 SF (1.31 Acres) Gross Site Area
- Divisible to roughly half the site (~28,500 SF / 0.66 Acres)
- Rate: \$0.50/SF/Month, Triple Net
- Available immediately
- Will consider MTM to up to 5 year lease terms
- Secured, paved & lit vehicle parking or laydown storage lot
- Total Estimated Automobile Storage: 175 Stalls (Tandem)
- Totem Lake Industrial (TL-7B), City of Kirkland
- Easy Access to downtown Redmond, Kirkland & Bellevue

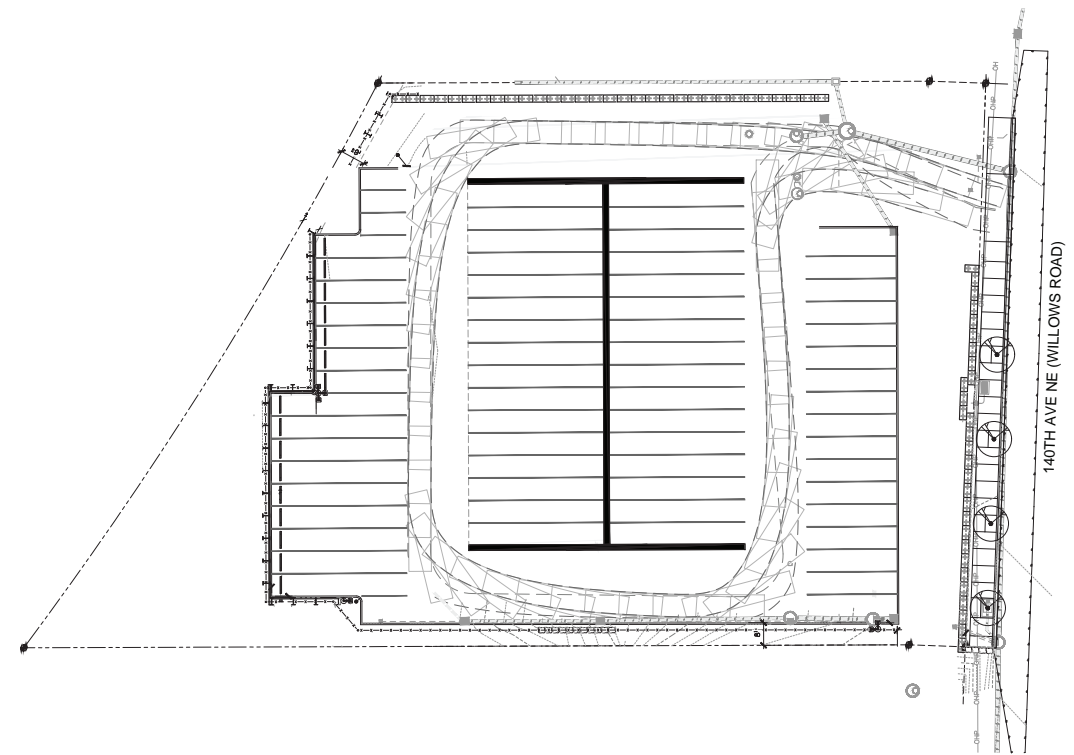



WILLOWS ROAD NE SECURED, PAVED & LIT STORAGE LOT

PLEASE CONTACT:

Kip Durrell

Executive Vice President
+1 425 462 6972
kip.durrell@cbre.com

Jeff Jochums

Executive Vice President
+1 425 462 6971
jeff.jochums@cbre.com

Brian Kenny

Vice President
+1 425 462 6910
brian.kenny@cbre.com

Rob Baker

Transaction Specialist
+1 425 462 6974
robert.baker@cbre.com

© 2026 CBRE, Inc. All rights reserved. This information has been obtained from sources believed reliable, but has not been verified for accuracy or completeness. You should conduct a careful, independent investigation of the property and verify all information. Any reliance on this information is solely at your own risk. CBRE and the CBRE logo are service marks of CBRE, Inc. All other marks displayed on this document are the property of their respective owners, and the use of such logos does not imply any affiliation with or endorsement of CBRE. Photos herein are the property of their respective owners. Use of these images without the express written consent of the owner is prohibited.

12633 Willows Road NE, Kirkland, WA 98034