

FOR LEASE

6TH & UNION CENTER

3602 6TH AVE, TACOMA, WA 98406

1,364 SF
AVAILABLE

KIDDER.COM

km Kidder
Mathews

6TH & UNION CENTER



AVAILABLE FOR LEASE

Method Labs Tutoring Center Coming Soon

PROPERTY OVERVIEW

Estimated NNN Expenses: \$11.08 PSF

Open Interior with Tall Ceilings providing flexible layout options

On-Site Parking Available for customers and staff

Immediate proximity to Downtown Tacoma and convenient access to Interstate 5

Minutes from the University of Puget Sound, contributing to consistent daytime activity

Located within a well-established residential neighborhood, offering a strong local customer base

Surrounded by an eclectic blend of dining, retail, and service businesses that anchor the corridor's appeal

AVAILABILITIES

Suite	Former Use	SF	Rate
SUITE 103	India Garden Restaurant	1,364 SF	Call for Rate

NEARBY TENANTS



KIDDER MATHEWS

6TH & UNION CENTER



DEMOGRAPHICS

POPULATION

	5 Minutes	10 Minutes	15 Minutes
2020 CENSUS	46,561	125,977	233,305
2010 CENSUS	42,302	112,709	209,919
2025 ESTIMATED	45,367	136,945	245,435
2030 PROJECTED	45,482	141,412	251,163

MEDIAN AGE & GENDER

	5 Minutes	10 Minutes	15 Minutes
MEDIAN AGE	37.7	37.8	37.4
% FEMALE	49.1%	48.9%	49.7%
% MALE	50.9%	51.1%	50.3%

HOUSEHOLD INCOME

	5 Minutes	10 Minutes	15 Minutes
2025 MEDIAN	\$101,721	\$90,824	\$90,542
2030 MEDIAN PROJECTED	\$101,969	\$89,530	\$89,822
2025 AVERAGE	\$132,244	\$119,550	\$118,908
2030 AVERAGE PROJECTED	\$132,694	\$118,005	\$118,133

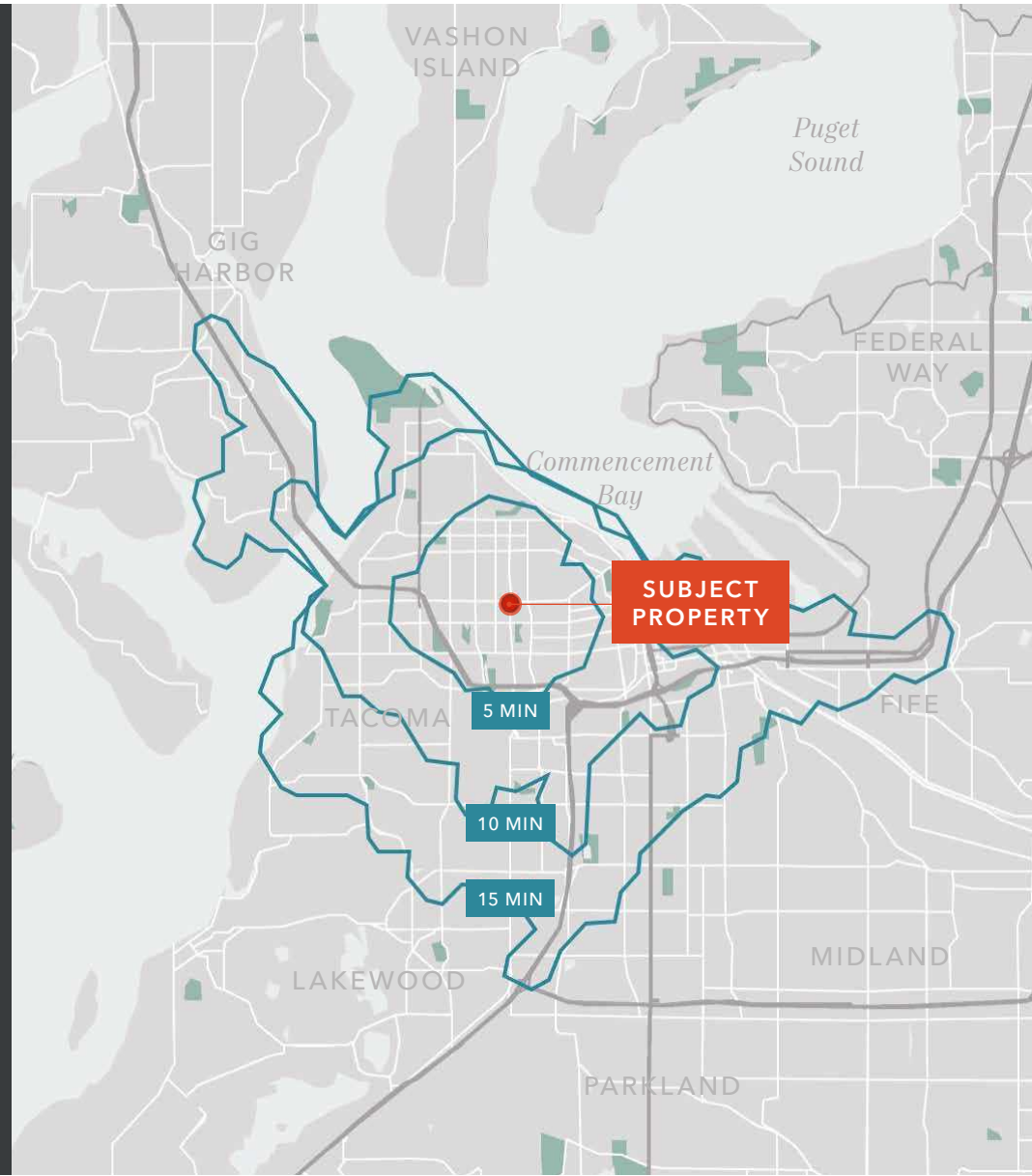

SITE PLAN

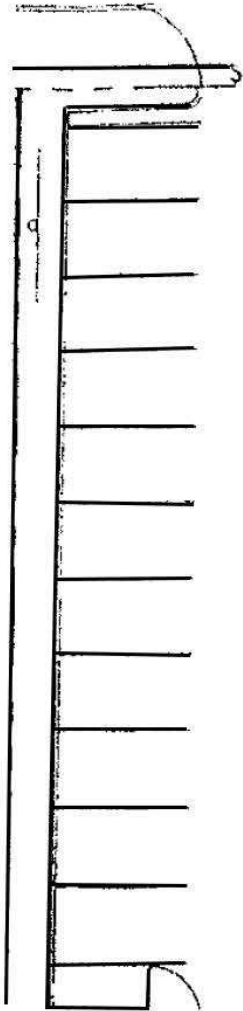

UNION ST



6TH & UNION CENTER

Exclusively leased by

BLAKE WEBER

Senior Vice President

206.898.1231

blake.weber@kidder.com

TIM WEBER

Executive Vice President

206.650.0391

tim.weber@kidder.com

NED WHALEN

Senior Vice President

206.491.5998

ned.whalen@kidder.com

DON WHITTLES

Senior Vice President

253.208.2257

don.whittles@kidder.com

KIDDER.COM

This information supplied herein is from sources we deem reliable. It is provided without any representation, warranty, or guarantee, expressed or implied as to its accuracy. Prospective Buyer or Tenant should conduct an independent investigation and verification of all matters deemed to be material, including, but not limited to, statements of income and expenses. Consult your attorney, accountant, or other professional advisor. All Kidder Mathews designs are the sole property of Kidder Mathews. Branded materials and layouts are not authorized for use by any other firm or person.