

INDEX MAP

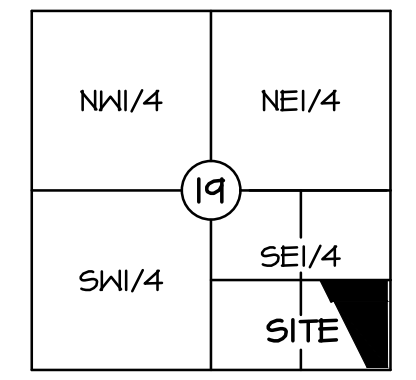

SECTION 19 TWP.31 N., RGE.05 E., W.M.

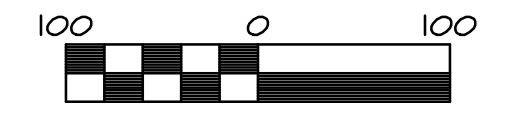

Scale 1" = 100'

BASIS OF BEARING
SOUTH LINE OF SECTION 19 PER R-1 AS SHOWN HEREON.

LEGAL DESCRIPTION
ALL THAT PORTION OF THE SOUTHEAST 1/4 OF THE SOUTHEAST 1/4 OF SECTION 19, TOWNSHIP 31 NORTH, RANGE 5 EAST, W.M., LYING EASTERLY OF THE GREAT NORTHERN RAILWAY RIGHT OF WAY, LESS COUNTY ROAD, SNOHOMISH COUNTY, WASHINGTON.
SITUATE IN THE COUNTY OF SNOHOMISH, STATE OF WASHINGTON.
(LEGAL DESCRIPTION PER STATUTORY WARRANTY DEED RECORDED UNDER A.F.N. 201910170417).

REFERENCES
R-1 R.O.S FOR MYRON GEMMER BY ASE&T; AFN:200701125006.
R-2 R.O.S. FOR JACK BAKER BY NORTH POINT SURVEYING; AFN:200904215003.

SURVEY NOTES
1. SECTION SUBDIVISION AND BOUNDARY SOLUTION PER RECORD OF SURVEY AFN:200701125006 (R-1).
2. THIS IS A PAPER BOUNDARY ONLY. NO FIELD WORK WAS PERFORMED IN THE COURSE OF THIS PROJECT. THE BOUNDARY WAS PRODUCED UTILIZING THE ASE&T SURVEY (R1).
3. NO TITLE REPORT WAS FURNISHED FOR THIS PROJECT. THE PROPERTY MAY BE SUBJECT TO EASEMENTS OF RECORD OR OTHERWISE.

SITE INFORMATION
PARCEL ID: 31051900401200
PROPERTY ADDRESS: 17406 19TH AVE NE
CITY: MARYSVILLE
ZIP CODE: 98271
TAXPAYER: HANSON SISTERS LLC
OWNER: HANSON SISTERS LLC

31051900401200
PARCEL AREA
856,128 SF (19.65 AC.)
EXCLUDING THE ROAD RIGHT-OF-WAY ALONG THE EAST AND SOUTH LINES.

S.E. 1/4 OF THE S.E. 1/4,
SEC 19, TWP 31 N, RGE 5 E, WM
(PER R1).

BURLINGTON NORTHERN SANTA FE RAILROAD
(GREAT NORTHERN RAILROAD)
(PER R-1)

REV. 00 JSM 2/11/20

| | |
|---|---|
| | ANDES LAND SURVEYING, P.S. 1523 TENTH ST, MARYSVILLE, WA 98270 PHONE: 425-350-5063 |
| | JOB DATA: 3105-19.03 202003 FB: N/A 3105-19.03 HANSON 2-11-20 |
| DRAWN BY: JSM CHECKED: JRA DATE: FEB 2020 | DATE: FEB 2020 |

BOUNDARY EXHIBIT
FOR
HANSON SISTERS, LLC

A PORTION OF S.E.1/4 S.E.1/4
SECTION 19, TOWNSHIP 31 NORTH, RANGE 05 EAST, W.M.
CITY OF MARYSVILLE, STATE OF WASHINGTON