

For Sale

NORTH PACIFIC INDUSTRIES BUILDING

*Stand alone single or
multi-tenant high quality
industrial building for sale*

8740 S 228TH ST
KENT, WA 98031





*22,230 SF available in Kent
(±3,324 SF office)*

3 dock-high and 2 grade level doors

Currently single tenant but ability to easily convert to a two-tenant building

High quality primary office build-out

20-22' clear height

I1- Industrial Business Zoning

→ [VIEW ZONING CODE](#) → [VIEW ZONING MAP](#)

New roof insulation and warehouse heaters

New LED warehouse and office lighting

Automatic garage doors

Fully fenced and secured

Fiber internet in building

Call brokers for pricing

22,230

SF AVAILABLE

±3,324

SF OFFICE

FLOOR PLAN

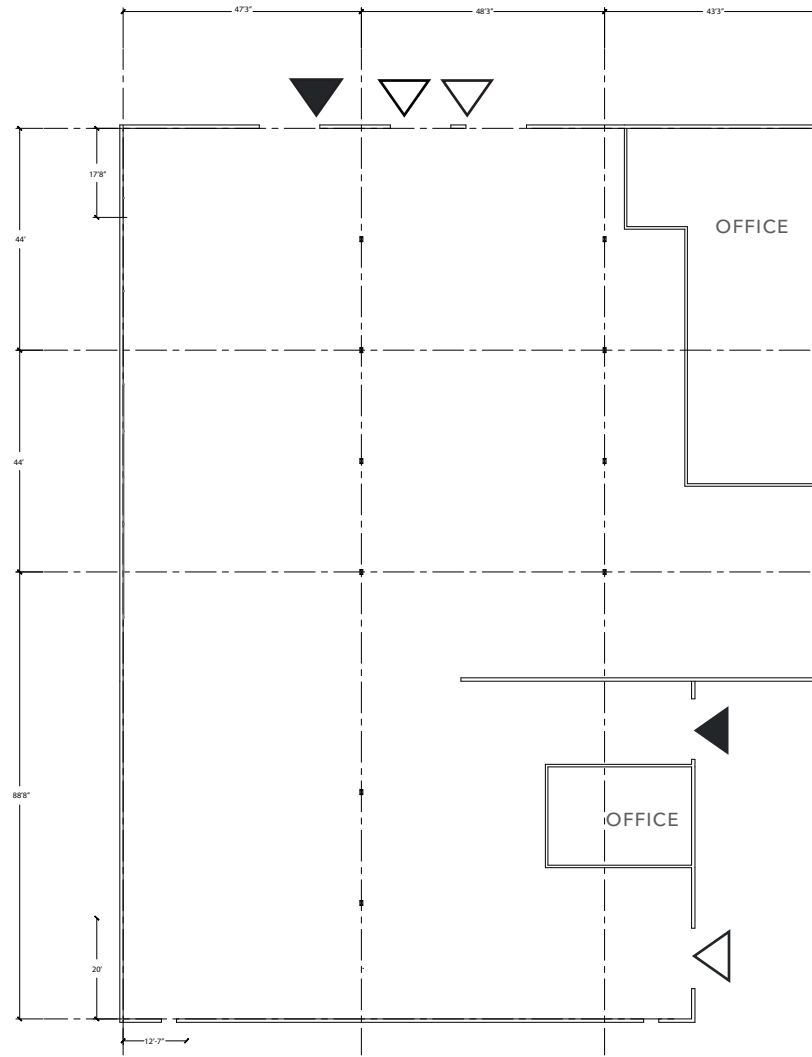
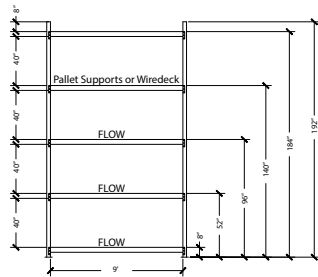

22,230 SF

AVAILABLE

KEY

△ Dock-high door

▲ Gradelevel door



Suite	Square Footage	Office Square Footage	Doors
Suite A	14,735 SF	2,316 SF	2 dock-high & 1 grade-level door
Suite B	7,477 SF	1,008 SF	1 dock-high & 1 grade-level door

8740 S
228TH ST

Exclusively listed by

MATT MCLENNAN, SIOR, CCIM
253.722.1458
matt.mclennan@kidder.com

TODD CLARKE
253.722.1422
todd.clarke@kidder.com

KIDDER.COM

This information supplied herein is from sources we deem reliable. It is provided without any representation, warranty, or guarantee, expressed or implied as to its accuracy. Prospective Buyer or Tenant should conduct an independent investigation and verification of all matters deemed to be material, including, but not limited to, statements of income and expenses. Consult your attorney, accountant, or other professional advisor.

