

# FOR SALE

## 816 RD 28

PASCO, WA

4.87 Acres +  
11,049 SF Bldg.

**Thad Mallory, SIOR**

Vice Chairman  
425.362.1410  
thad.mallory@nrmk.com

**Morgan Richey**

Managing Director  
425.362.1409  
morgan.richey@nrmk.com

**Josh Satterlee**

Associate  
206.453.1396  
josh.satterlee@nrmk.com

**NEWMARK**



816 Rd 28 / Pasco, WA

# PROPERTY SUMMARY

## OVERVIEW DETAILS

ADDRESS 816 Rd 28

LOT SIZE 4.87 Acres

TOTAL BUILDING SIZE 11,049 SF

SERVICE SHOP 5,904 SF

OFFICE/SHOWROOM 5,145 SF

CLEAR HEIGHT 14' - 22'

LOADING 4 GL Doors

PRICE \$3,900,000

BUILT 2015

AREAS

Break Room  
Lounge/Reception  
Picture Booth  
Private Offices

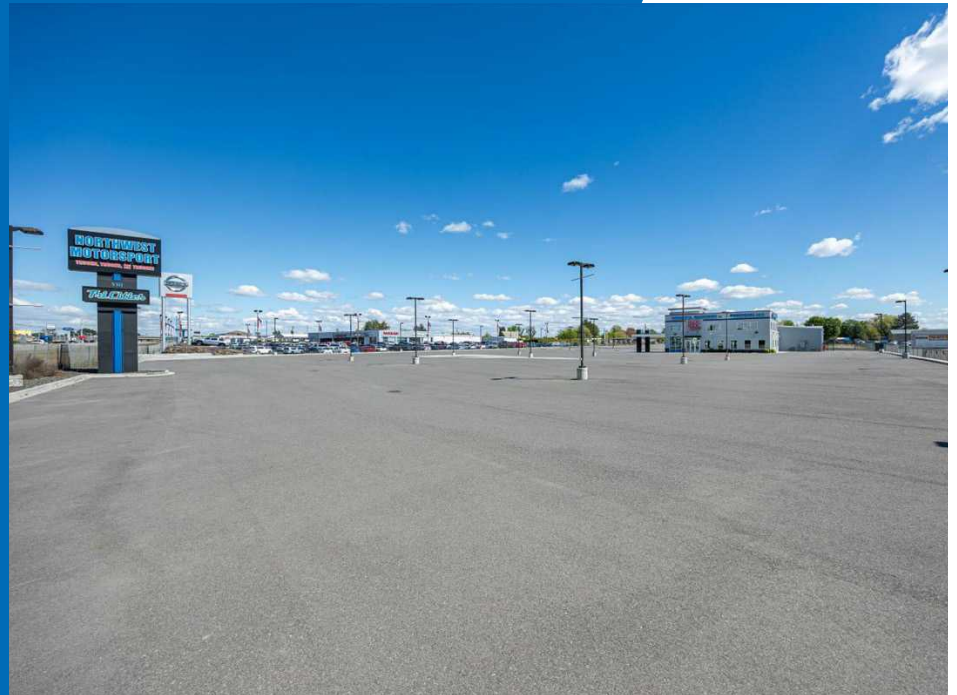

# PHOTOS



# FLOOR PLAN

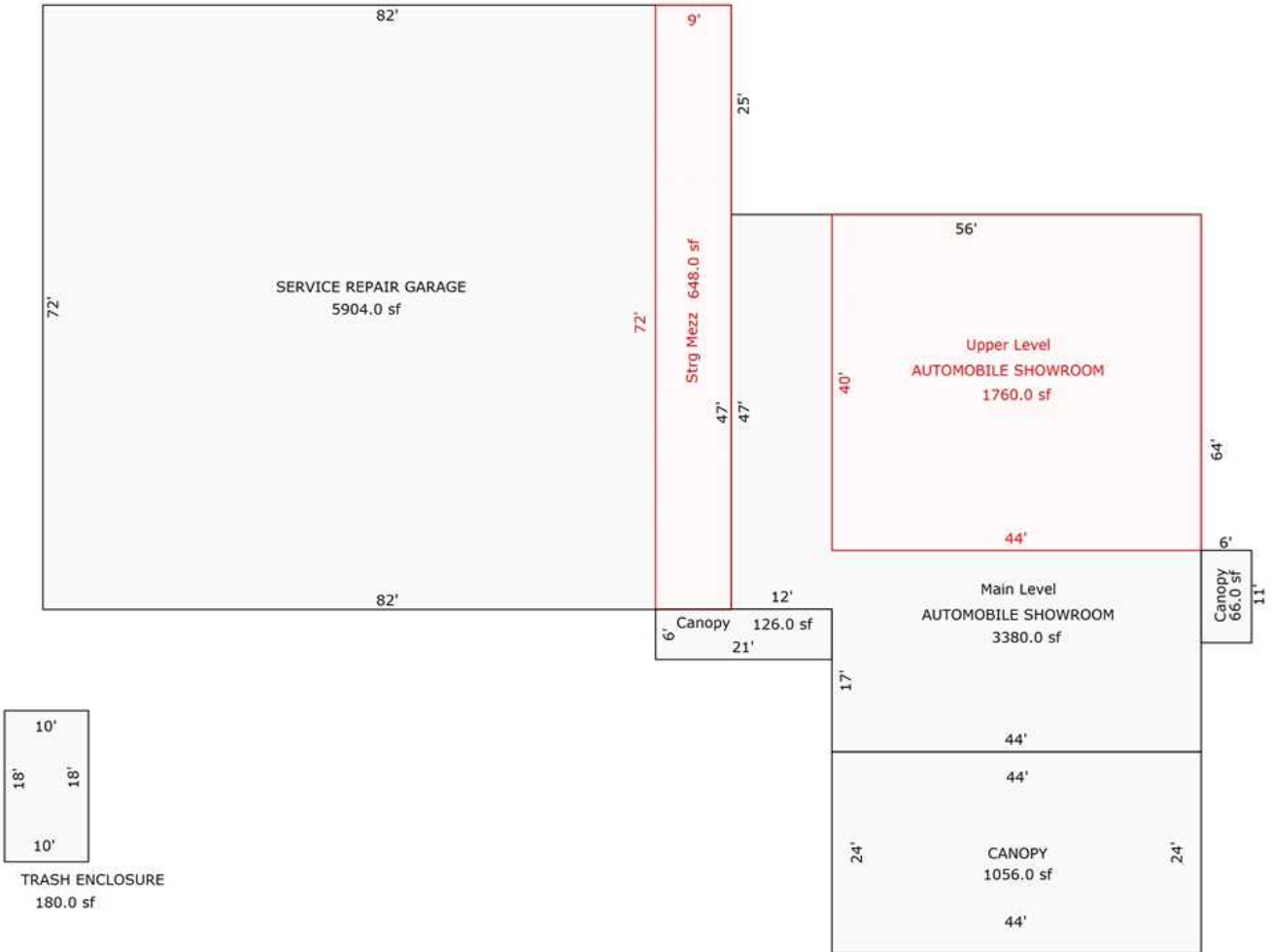

# LOCATION

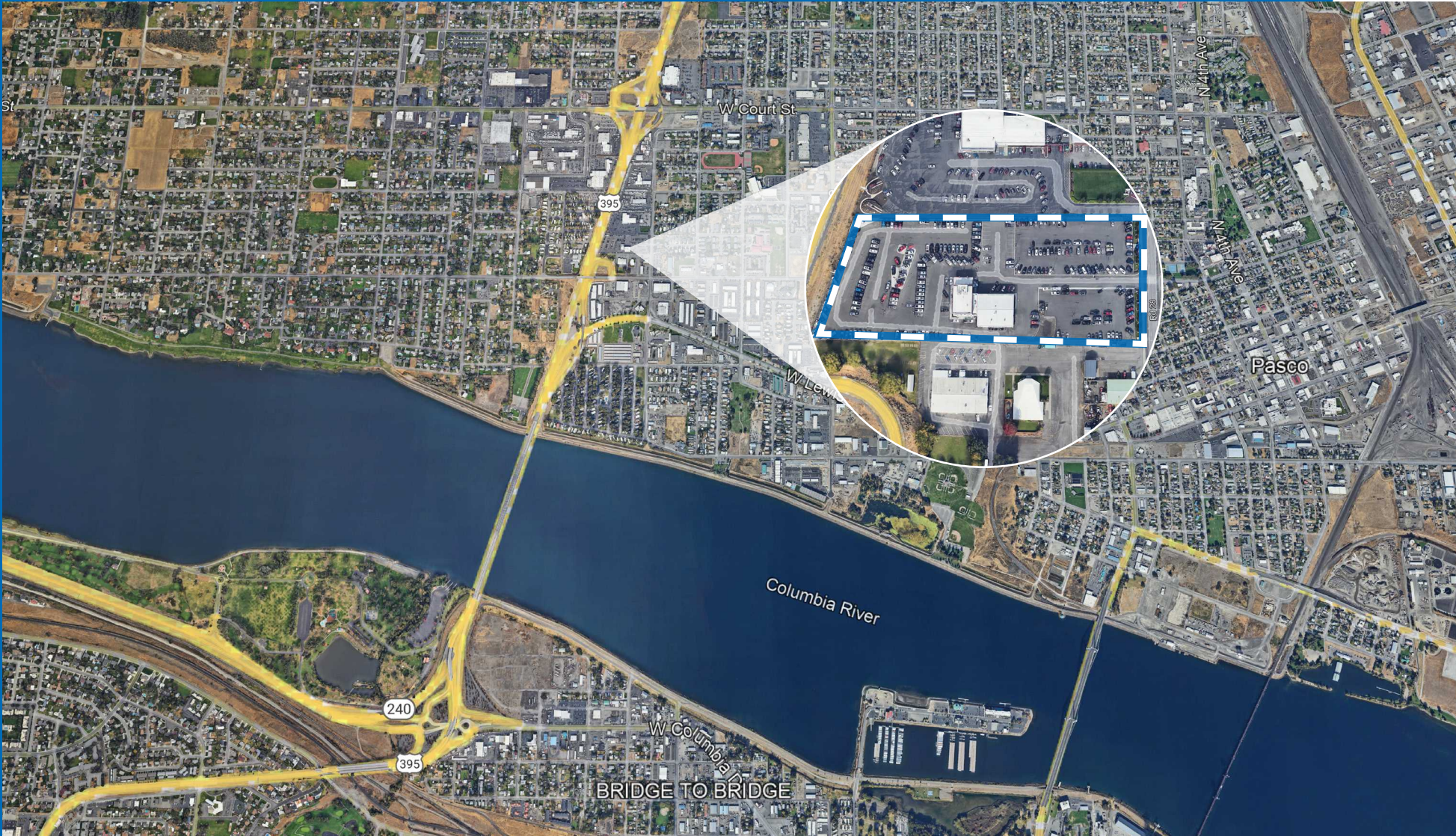

**NEWMARK**

The information contained herein has been obtained from sources deemed reliable but has not been verified and no guarantee, warranty or representation, either express or implied, is made with respect to such information. Terms of sale or lease and availability are subject to change or withdrawal without notice.