

# LITTLEROCK ROUNABOUT LAND

5945 Littlerock Road SW  
Tumwater, Washington

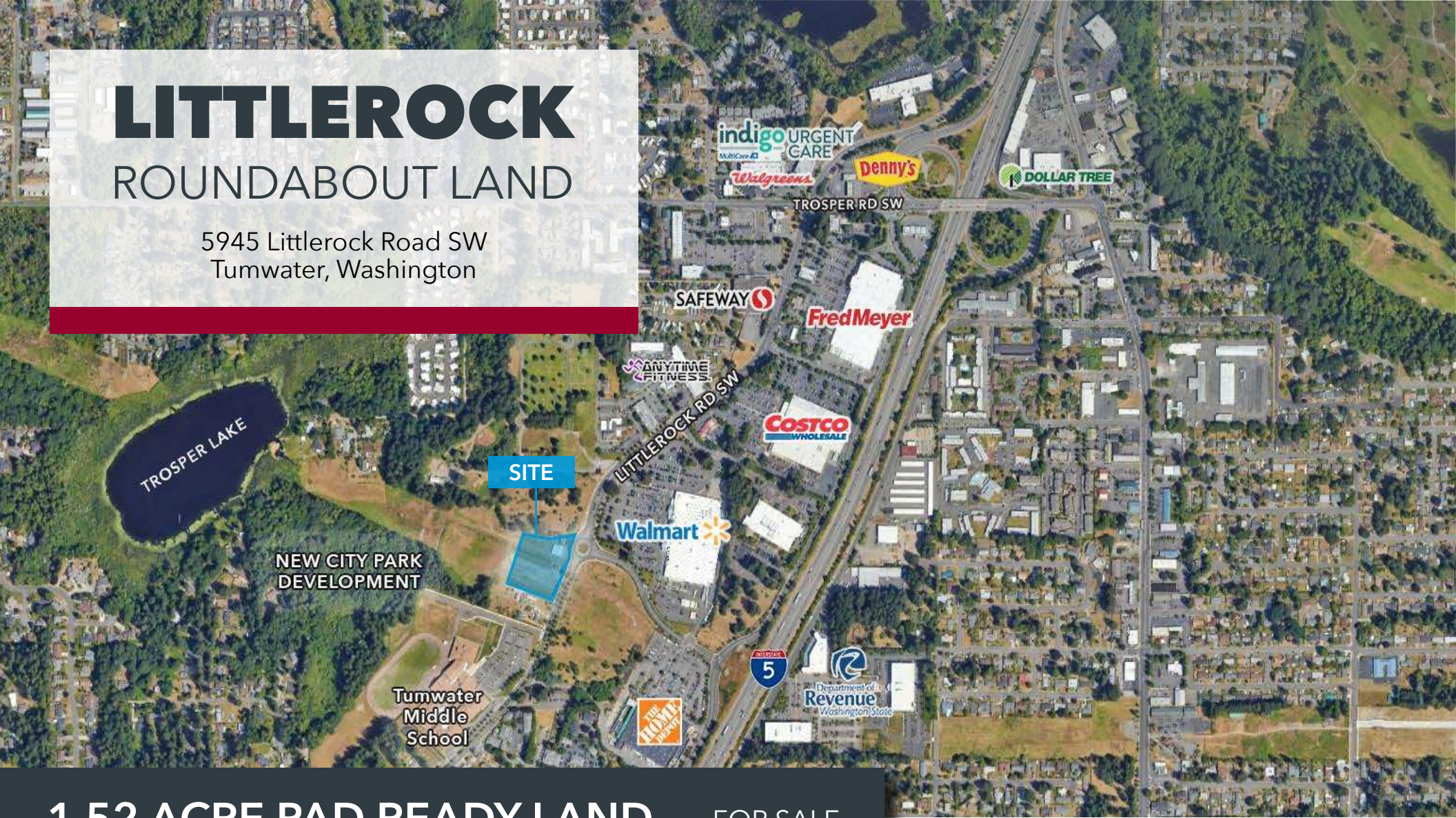

**1.52 ACRE PAD READY LAND**

**FOR SALE**

**KYLE PROSSER**

Principal  
D 253-444-3025  
kprosser@lee-associates.com

**TOM BROWN**

Principal  
D 253-444-3024  
tbrown@lee-associates.com

**BRUCE BARKER**

Associate Vice President  
D 253-341-0765  
bbarker@lee-associates.com



**LEE &  
ASSOCIATES**

COMMERCIAL REAL ESTATE SERVICES

*All information furnished regarding property for sale, rental or financing is from sources deemed reliable, but no warranty or representation is made to the accuracy thereof and same is submitted to errors, omissions, change of price, rental or other conditions prior to sale, lease or financing or withdrawal without notice. No liability of any kind is to be imposed on the broker herein.*

# PROPOSED SITE PLAN

1.52 Acre retail pad for sale, located at the roundabout across from Walmart with great visibility and access. Great access to the roundabout. New tenants across the street include a Towneplace Suites Marriott, Starbucks, Wendy's and more.



# SITE PLAN

## PENDING SHORT PLAT

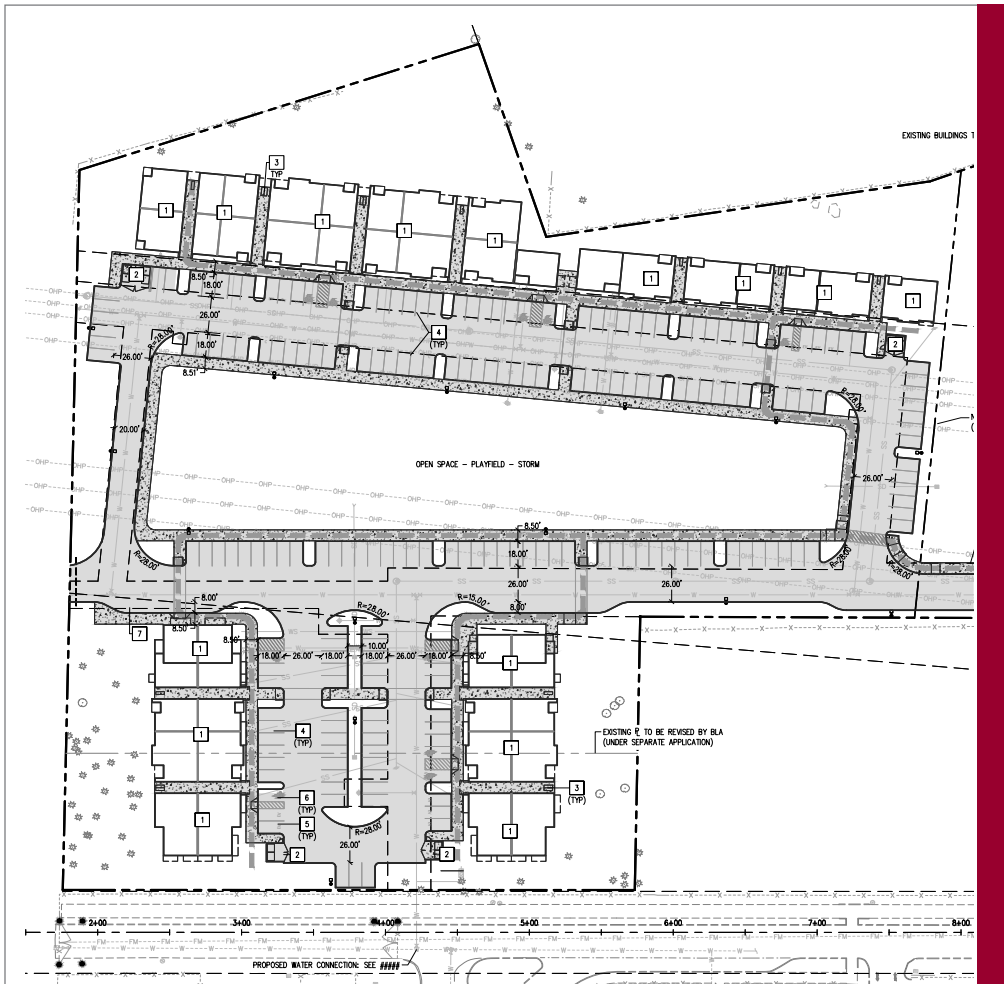

**LAND AREA:**

Approximately 1.52 acres

**PARCEL NUMBER(S):**

Short plat in process; shall be completed prior to closing at no cost to Buyer

**ZONING:**

General Commercial (GC)

**SALE PRICE:**

\$1,150,000

**PERMITTED USES:**

Restaurants, drive-thrus, banks, gyms, general retail, gas, medical, daycare, car wash

# DEVELOPMENT ALTERNATIVES

OPTION A

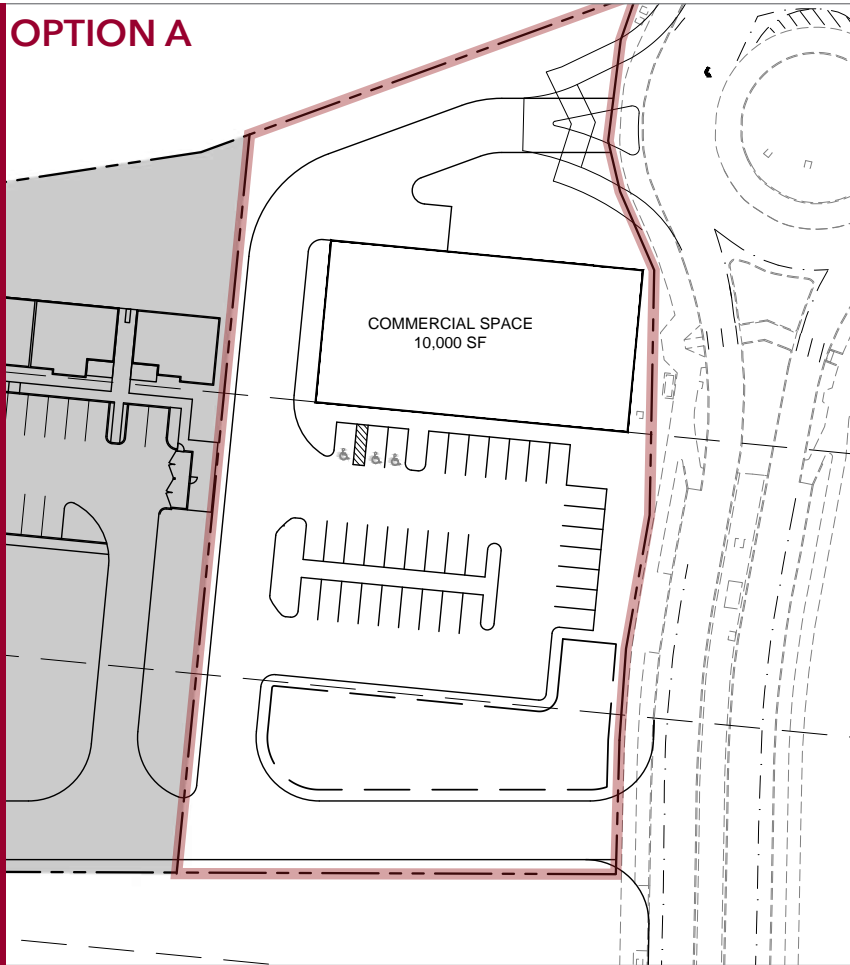

OPTION B

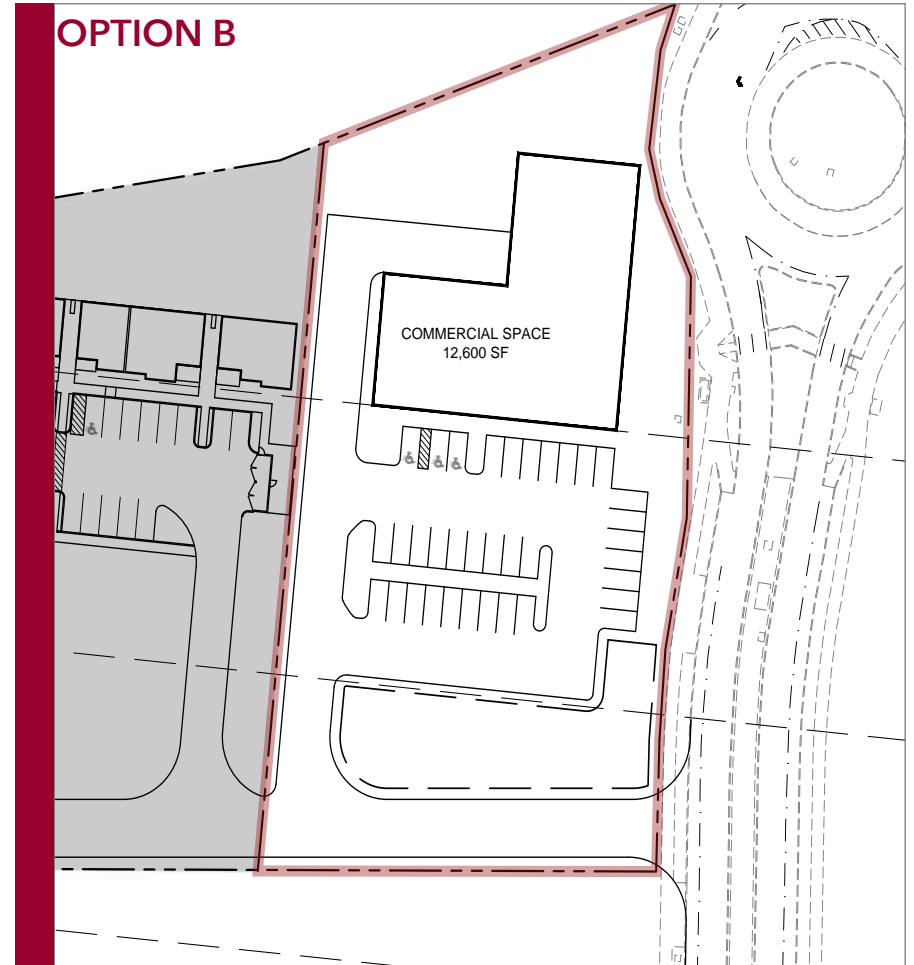

# MARKET STATISTICS

| POPULATION       | 1 MILE | 3 MILES | 5 MILES |
|------------------|--------|---------|---------|
| Total Population | 5,568  | 42,506  | 104,814 |
| Average Age      | 43     | 40      | 42      |

| HOUSEHOLDS & INCOME | 1 MILE   | 3 MILES   | 5 MILES   |
|---------------------|----------|-----------|-----------|
| Total Households    | 2,608    | 17,702    | 44,033    |
| Average HH Income   | \$84,742 | \$109,634 | \$107,358 |

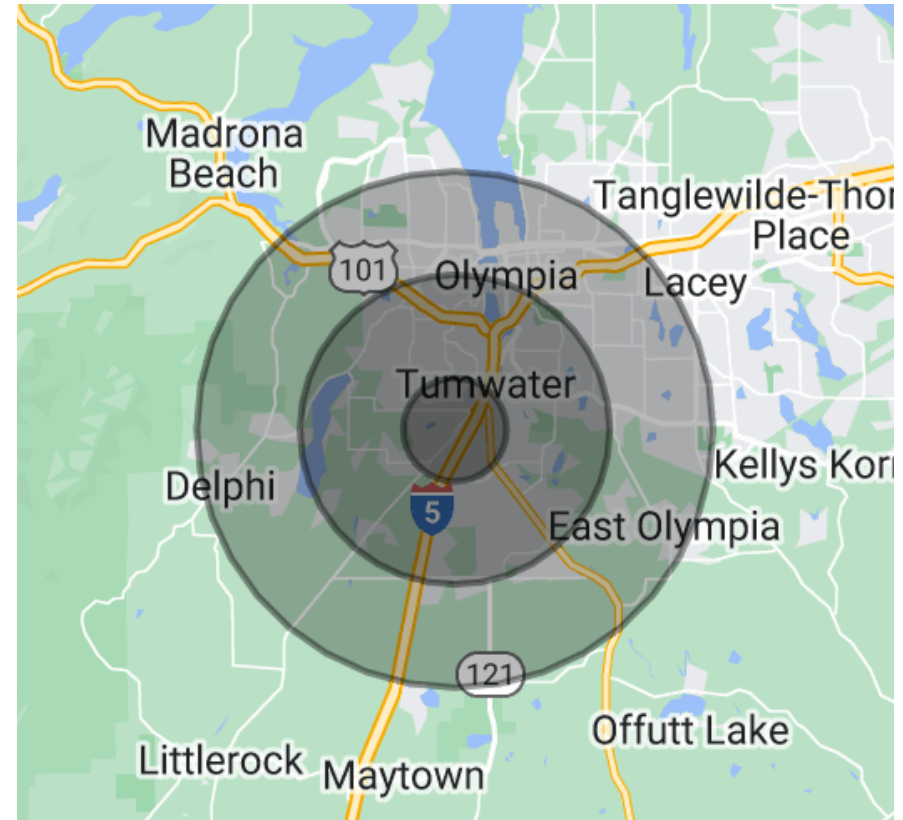

**KYLE PROSSER**  
Principal  
D 253-444-3025  
kprosser@lee-associates.com

**TOM BROWN**  
Principal  
D 253-444-3024  
tbrown@lee-associates.com

**BRUCE BARKER**  
Associate Vice President  
D 253-341-0765  
bbarker@lee-associates.com

950 Pacific Avenue, Suite 200, Tacoma, WA 98402 [O 253-383-8382](tel:253-383-8382) | [lee-nw.com](http://lee-nw.com)

## DISCLAIMER

We obtained the information above from sources we believe to be reliable. However, we have not verified its accuracy and make no guarantee, warranty or representation about it. It is submitted subject to the possibility of errors, omissions, change of price, rental or other conditions, prior sale, lease or financing, or withdrawal without notice. We include projections, opinions, assumptions or estimates for example only, and they may not represent current or future performance of the property. You and your tax and legal advisors should conduct your own investigation of the property and transaction.