

# 320 BIRCH STREET

FOR SALE: 2.54 INDUSTRIAL ACRES

MILTON, WA 98354

## INDUSTRIAL PROPERTY FOR SALE / PRIME I-5 VISIBILITY



### SALE INFORMATION

**SEPA Approval 95% Complete**  
**Expect Final MDNS January 2025**

<b>Land Size:</b>	±2.54 AC
<b>Zoning:</b>	M-1 Light Mftg (City of Milton)
<b>Building Size:</b>	SEPA for ±45,713 SF
<b>Office Size:</b>	Build-to-suit
<b>Loading:</b>	1 GL & 16 DH Doors
<b>Flexibility:</b>	Buyer can design alternative building
<b>Sale Price (Land):</b>	Call broker for details



**SCOTT PRICE**  
253.779.2419

sprice@neilwalter.com

**SAM HIGHSMITH**  
253.779.2434

shighsmith@neilwalter.com

All information references in this document are approximate. The information contained herein is contained from sources deemed reliable. It is provided without representation, warranty, or guarantee, expressed or implied as to accuracy. Prospective buyer or tenant should conduct its own independent investigation relating to the property, government codes and regulations, allowed uses, and all other matters, regardless of whether they are referred to or contained in this document.

# 320 BIRCH STREET

MILTON, WA 98354



Building Size	Office Size	Dock High Doors	Grade Level Doors
± 45,713 SF	Build-to-suit	16	1

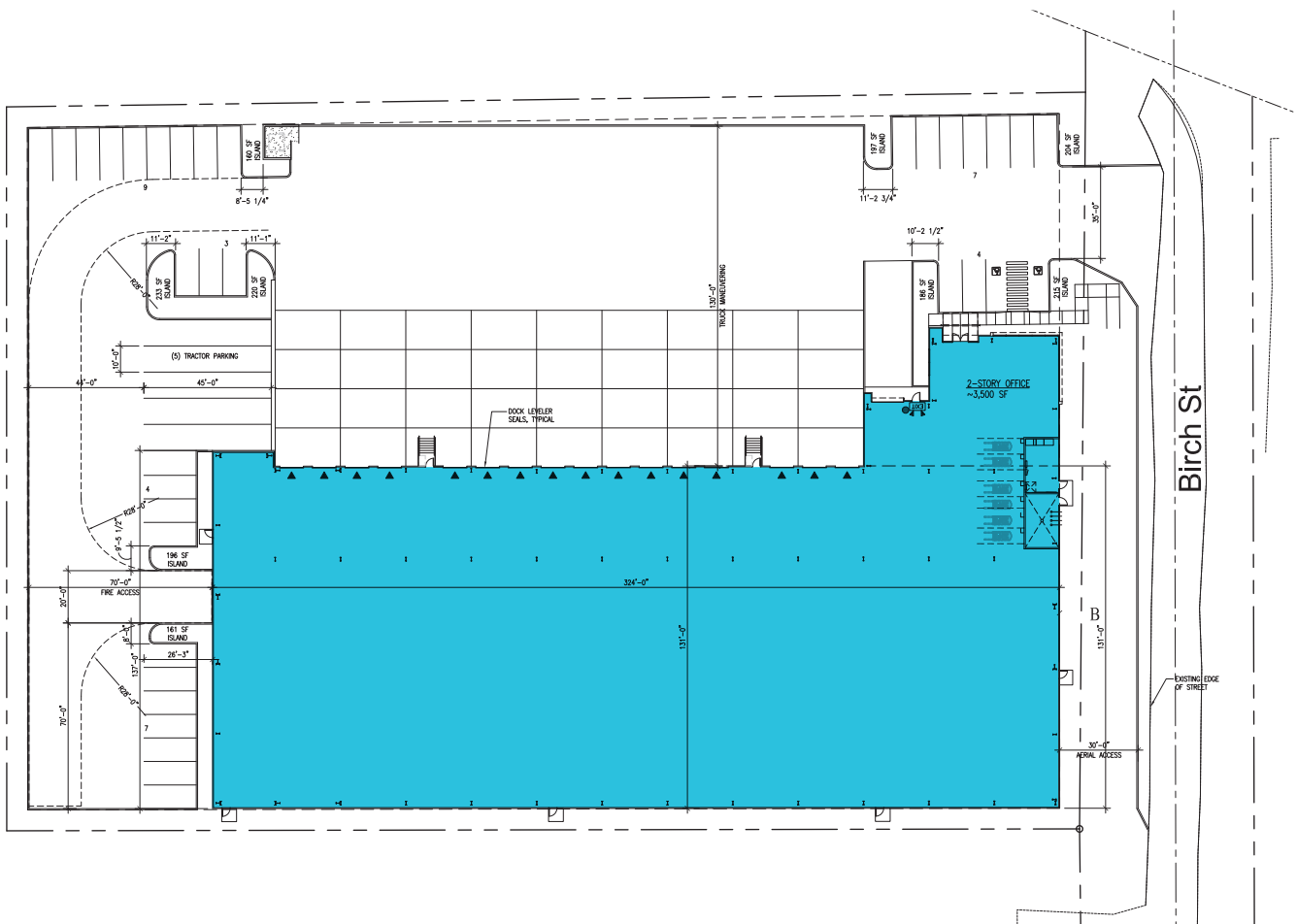

**SCOTT PRICE**  
253.279.3710  
sprice@neilwalter.com

**SAM HIGHSMITH**  
253.779.2434  
shighsmith@neilwalter.com

550 S Michigan St  
Seattle, WA 98108  
206.787.1800  
www.neilwalter.com

All information references in this document are approximate. The information contained herein is contained from sources deemed reliable. It is provided without representation, warranty, or guarantee, expressed or implied as to accuracy. Prospective buyer or tenant should conduct its own independent investigation relating to the property, government codes and regulations, allowed uses, and all other matters, regardless of whether they are referred to or contained in this document.