



LINCOLN NORTH

1221 LINCOLN STREET | BELLINGHAM, WA 98229

1221 LINCOLN STREET BELLINGHAM, WA 98229

PROPERTY	LINCOLN NORTH
PARCEL	189837
PARCEL SIZE	2.46 AC
ZONING	Commercial
RATE	CALL FOR RATE

2.46 acre retail or multifamily site located in Bellingham adjacent to Fred Meyer and Whole Foods. Site has conditional approval from the City of Bellingham for 200 units. Located just south of Fred Meyer, this property is zoned commercial and has access in two locations off Lincoln Street. The property has excellent frontage along Lincoln Street directly next to 649 student housing apartments. Property is available for ground lease or sale.



PLAN

Maximum 200 Studio Units
 175 Parking Stalls (8'10"x15' typical)
 NFPA13 Fully Sprinklered

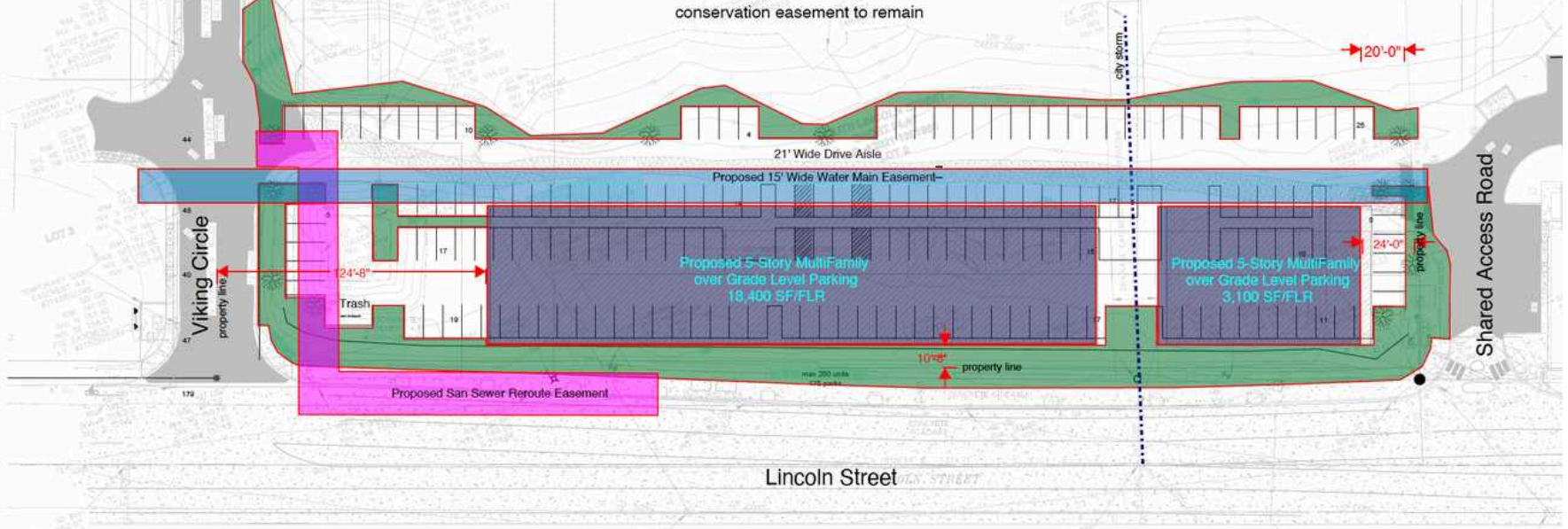

ELEVATION





TYSON CLARKE

SENIOR VICE PRESIDENT | PARTNER
TYSON@PAADVISORS.COM

360.319.4855

