

# High Visibility Development Lot in Coeur d'Alene

Offered at  
**\$489,000**

📍 3650 N Government  
Way, Coeur d'Alene, ID  
83815

Portion of AIN 167771

Traffic counts of 16,500  
cars per day

N Government Way



## 0.81 ACRE COMMERCIAL CONDO PLAT

Zoned C-17 in the city of Coeur d'Alene, This parcel has sewer and water stubs to the site. Just North of Costco and Safeway and south of Home Depot on Government Way. There are two existing buildings on the condo project. A developer could build a retail center with six units and sell off small retail units to owner users. Rare offering along busy Government way.

📞 **CRAIG HUNTER**

208.929.2929  
hunter@ccim.net



**CCIMTEAM.COM**

**KIEMLE  
HAGOOD**

1579 Riverstone Drive, #102  
Coeur d'Alene, ID 83814



Data is deemed reliable, no warranties or representations expressed or implied. Broker not responsible for changes, errors, omissions, or prior sale without notice. All critical measurements shall be done by Lessee or Buyer.

# Plat Map: 3650 N Government Way, Coeur d'Alene, Idaho

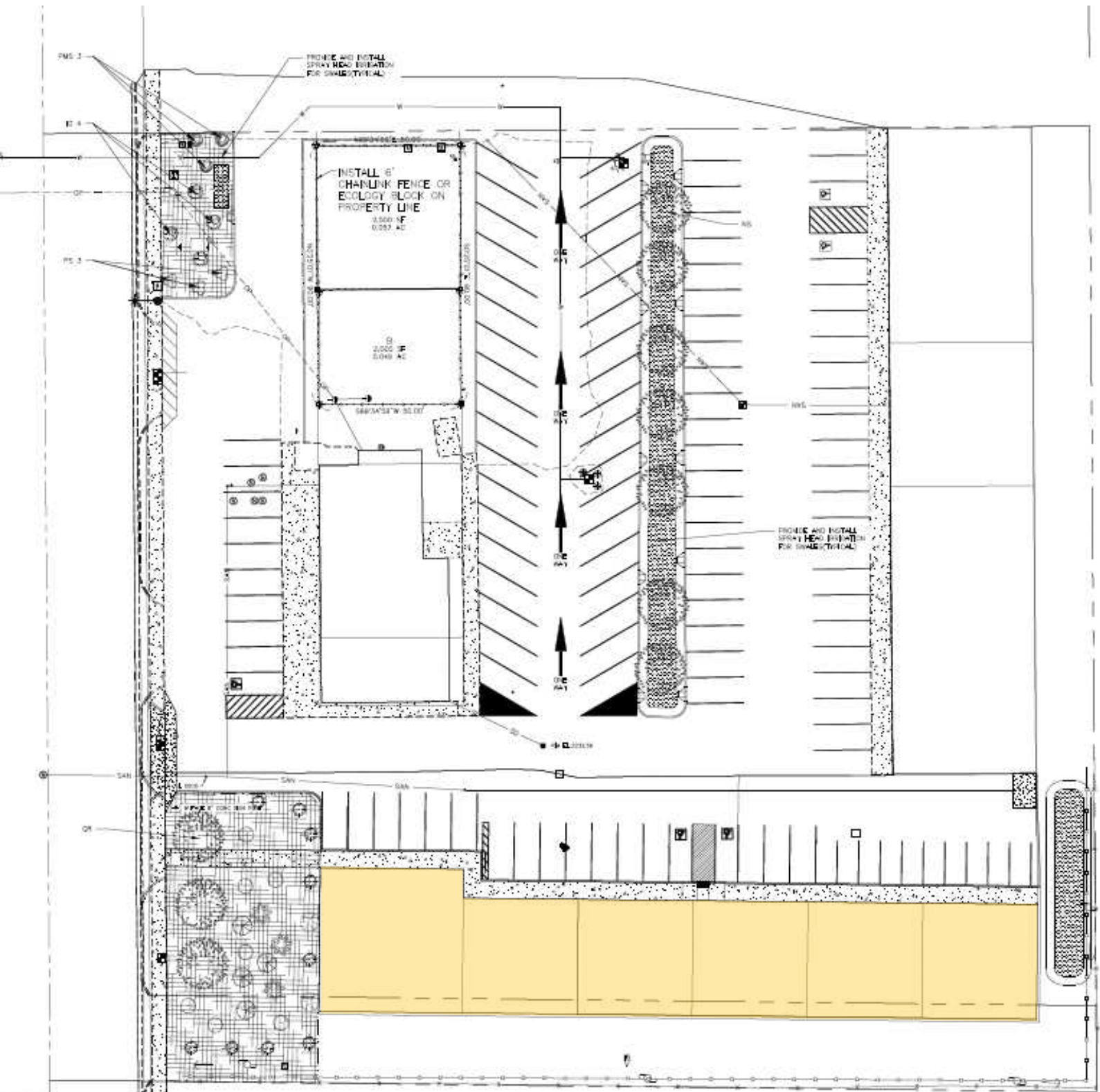

**CRAIG HUNTER**

208.929.2929 hunter@ccim.net



**CCIMTEAM.COM**

**KIEMLE  
HAGOOD**





Kathleen Avenue



N Government Way

W Sunset Avenue



Sunset  
Bowling  
Center



Car Wash



Cabinets North

Coins

Bridal



J.A. Bertsch  
Heating & Cooling LLC



CRAIG HUNTER

208.929.2929 hunter@ccim.net



CCIMTEAM.COM

KIEMLE  
HAGOOD