

Sale Price Reduced!

FOR SALE



WAREHOUSE CONDO FOR SALE

6720 N. Pittsburg St
Spokane, WA 99217

LOCATION:	North of Francis between Nevada and Market Street, only 8 blocks west of the North Spokane Corridor.		
SITE:	A portion of a ±28,067 SF site, parcel 36283.2924; within Lyons Park Warehouse Condo Owners Assoc.		
ZONING:	City of Spokane LI, Light Industrial		
IMPROVEMENTS:	Total Footprint:	±3,746 SF, per county records, includes one restroom	
	Heat:	Two (2) gas fired unit heaters	
	Sewer & Water:	City of Spokane	
	Construction Type:	Steel frame, metal siding	
	Ceiling Height:	18'	
	Loading:	One (1) grade level overhead door, 14' x 14'	
	Age:	2005	
UTILITIES:	Separately metered for gas and electric;		
ASSOC. DUES:	±\$500.00/Mo includes sewer, water, garbage, maintenance, snow removal & landscape maintenance		
SALE PRICE:	675,000	\$595,000	

Steve McIntosh |
509.755.7546
sjm@kiemleahagood.com

Tracy Lucas |
509.755.7558
tracyl@kiemleahagood.com

JD Lucas |
509-862-5385
jd.lucas@kiemleahagood.com

**KIEMLE
HAGOOD**

All information herein is furnished by the owner and believed to be complete and correct. The Agent, however, cannot be responsible for changes, errors, omissions or withdrawals of this offering without notice. The above information is from sources deemed reliable but should be verified by parties that could be adversely affected by any statements or information. This is not an offering of sub-agency, with commission splits to be determined. 08/04/25/tp J:\BROKERS\LUCAS DOCS\FLYERS\Pittsburg N 6720PUB

WAREHOUSE CONDO FOR SALE

6720 N. Pittsburg St.
Spokane, WA 99217



FLOOR PLAN

6720 N. Pittsburg St.
Spokane, WA 99217

THIS DRAWING IS FOR CONVENIENCE ONLY. ALL CRITICAL MEASUREMENTS SHOULD BE VERIFIED BY PURCHASER OR LESSEE. ALL RIGHTS RESERVED.
NO PART OF THIS DOCUMENT MAY BE REPRODUCED IN ANY FORM OR BY ANY MEANS WITHOUT WRITTEN PERMISSION FROM TRACY LUCAS.

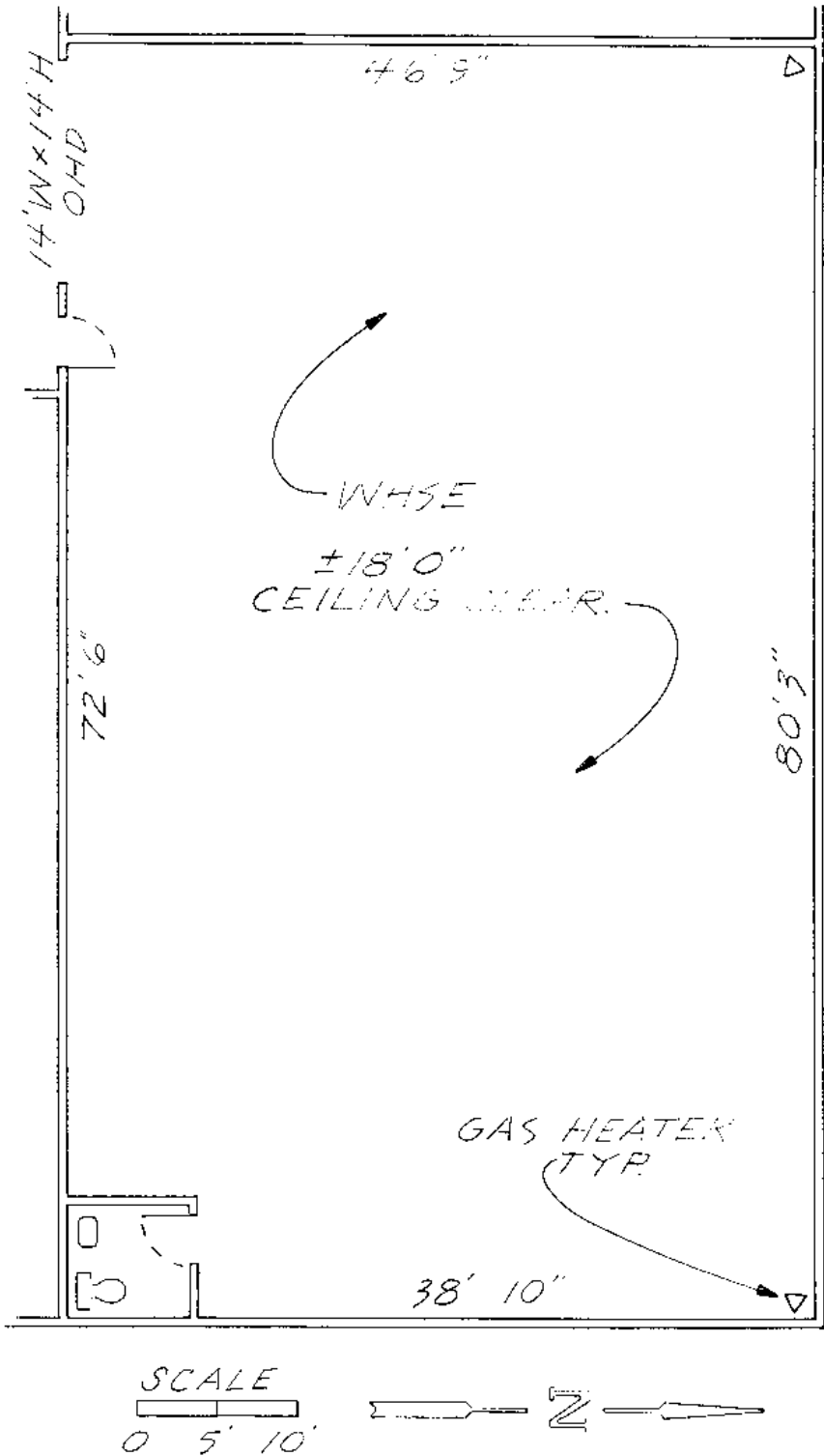

Steve McIntosh |
509.755.7546
sjm@kiemlehagood.com

Tracy Lucas |
509.755.7558
tracyl@kiemlehagood.com

JD Lucas |
509.862.5385
jd.lucas@kiemlehagood.com

6720 N. Pittsburg St., Spokane, WA 99217



Steve McIntosh |
509.755.7546
sjm@kiemlehagood.com

Tracy Lucas |
509.755.7558
tracyl@kiemlehagood.com

JDLucas |
509.862.5385
jd.lucas@kiemlehagood.com



601 W. Main Avenue, Suite 400
Spokane, WA 99201

OFFICE LOCATIONS
SPOKANE | COEUR D'ALENE | TRI-CITIES | MISSOULA

Kiemle Hagood respects the intellectual property of others: If you believe the copyright in your work has been violated through this Website, please contact our office for notice of claims of copyright infringement. For your complaint to be valid under the Digital Millennium Copyright Act of 1998 (DMCA), you must provide the following information when providing notice of the claimed copyright infringement: Identify the material on the Website that you believe infringes your work, with enough detail so that we may locate it on the Website; provide your address, telephone number and email address; provide a statement that you have a good faith belief that the disputed use is not authorized by the copyright owner, its agent, or the law; provide a statement that the information in the notification is accurate, and under penalty of perjury, that the complaining party is authorized to act on behalf of owner of an exclusive right that is allegedly infringed; provide your physical or electronic signature. Upon receiving your complaint, Kiemle Hagood will, upon review, remove content that you believe infringes your copyright if the complaint is found valid.