



For Sale

Development Opportunity

Sammamish, WA

4.77 Acres of R-4 Zoned Land

- In the heart of Sammamish, one of the most sought after residential areas in the country
- Award winning Lake Washington School District
- Slight slope to property, utilities adjacent

Parcel	272506-9144	272506-9002	Total
Land SF	40,000	167,900	207,900
Acres	0.92	3.85	4.77
Zoning	R-4	R-4	R-4
2025 Taxes	\$2,883.24	\$ 8,000.39	\$10,883.63
Sewer	Yes	None	

Contact Us

Jeff Jeremiah

Senior Vice President
+1 425 453 3123
jeff.jeremiah@colliers.com



Colliers

11225 SE 6th Street, #240
Bellevue, WA 98004
colliers.com

Property Information

Development Opportunity Sammamish, WA

The property is currently vacant and is zoned R-4, yielding a potential 19 single family homes in a desirable neighborhood. The City of Sammamish, in an effort to increase density and address housing supply constraints, has adopted a Middle Housing Overlay to apply to properties zoned R-4. Please see the Sammamish Municipal Code for further information.

[Click to Learn More About R-4 Zoning](#)

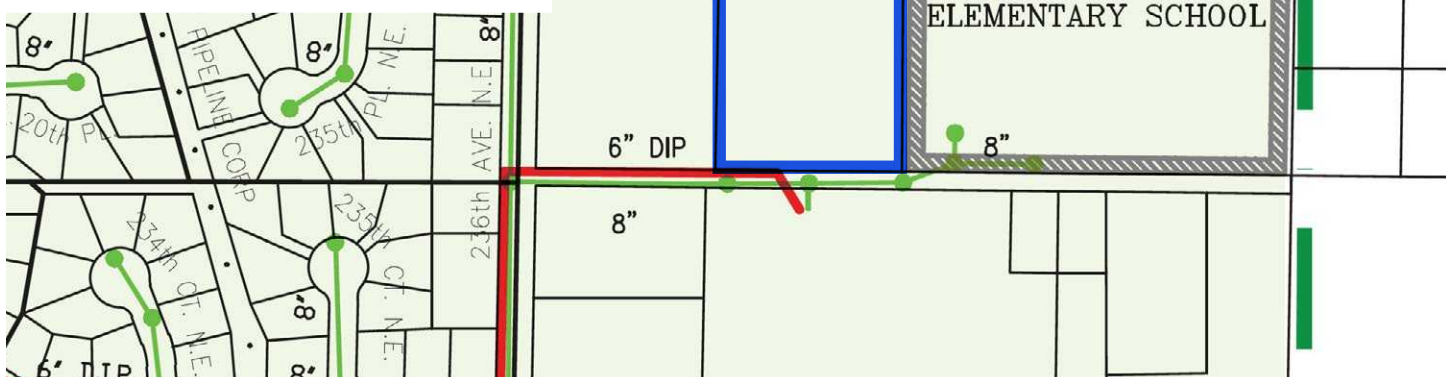
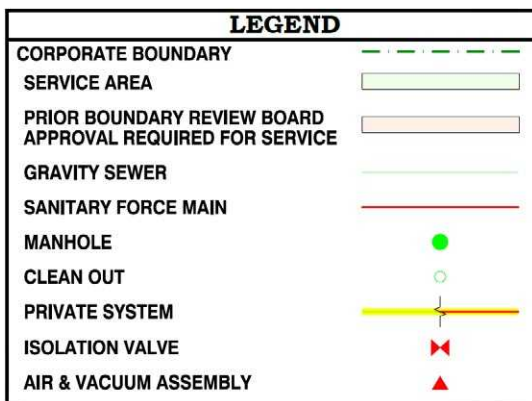
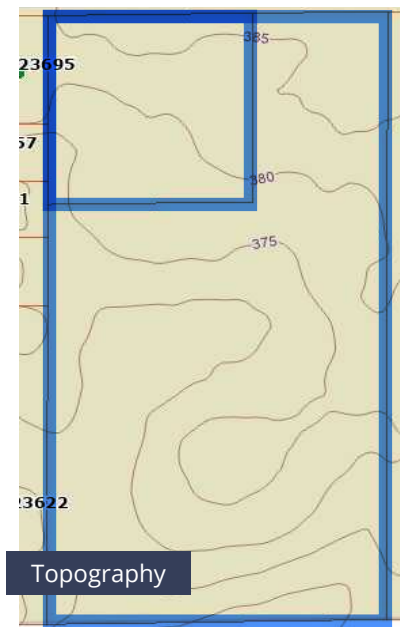
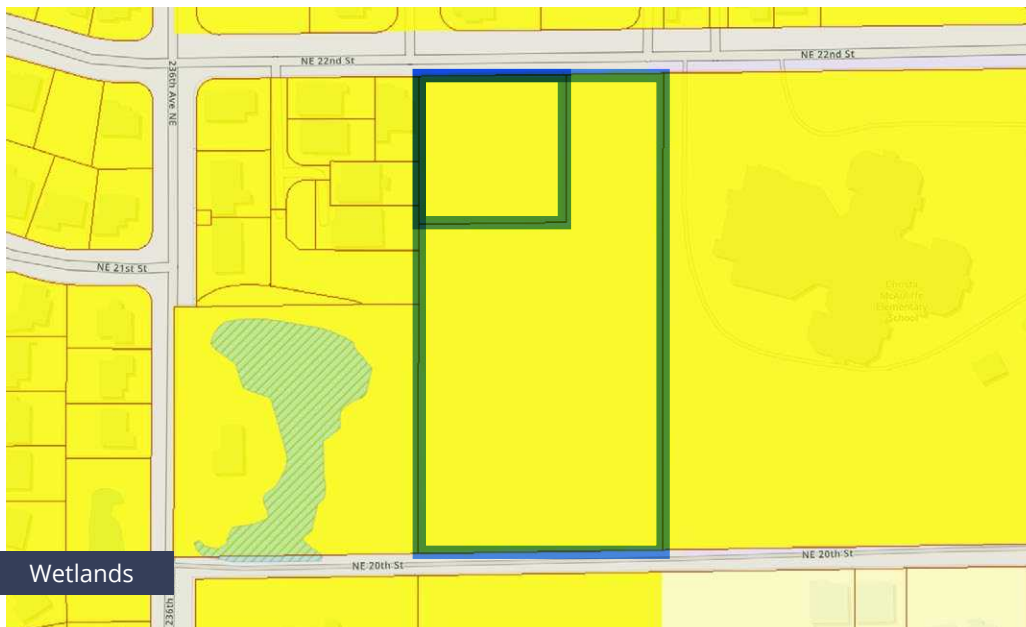

Sammamish, Washington, is a suburban city located on a scenic plateau east of Lake Sammamish, nestled between Redmond and Issaquah in King County. Known for its **natural beauty, top-rated schools, and family-friendly atmosphere**, Sammamish has grown rapidly since its incorporation in 1999. With a population of around 68,000, **it consistently ranks among the best places to live in the U.S.**, thanks to its **high median household income, low crime rates, and excellent quality of life.**

Sammamish offers a high quality of life through its abundant green spaces, parks, and trails that support recreation, wellness, and a strong connection to nature. The city is also investing in community infrastructure—such as walkable retail areas, civic spaces, and a developing Town Center—to enhance convenience, social engagement, and local services. Combined with excellent schools, a safe environment, and a strong focus on environmental preservation, these amenities make Sammamish an **ideal place for families** and outdoor enthusiasts alike.



	1 mile	3 miles	5 miles
Total Population	9,124	45,655	125,664
5 Year Projected Population	9,388	46,259	127,136
Current Median Household Income	\$290,283	\$264,888	\$230,267
5 Year Projected Median Household Income	\$311,629	\$296,883	\$266,006
Current Per Capita Income	\$107,510	\$103,282	\$99,900
5 year Projected Per Capita Income	\$116,058	\$112,495	\$110,030
Median Home Value	\$1,303,998	\$1,355,428	\$1,330,400



Jeff Jeremiah
Senior Vice President
+1 425 453 3123
jeff.jeremiah@colliers.com

This document/email has been prepared by Colliers for advertising and general information only. Colliers makes no guarantees, representations or warranties of any kind, expressed or implied, regarding the information including, but not limited to, warranties of content, accuracy and reliability. Any interested party should undertake their own inquiries as to the accuracy of the information. Colliers excludes unequivocally all inferred or implied terms, conditions and warranties arising out of this document and excludes all liability for loss and damages arising there from. This publication is the copyrighted property of Colliers and /or its licensor(s). © 2025. All rights reserved. This communication is not intended to cause or induce breach of an existing listing agreement.