

FOR SALE



LEASED OFFICE & WAREHOUSE | 414 N. Sycamore St., Spokane, WA 99202

| | | |
|----------------------|---|---|
| LOCATION: | Great central location just east of Freya within minutes to I-90, Spokane's Central Business District and Spokane Valley. | |
| SITE: | ±37,500 SF; parcel #35154.1701 | |
| ZONING: | City of Spokane HI, Heavy Industrial | |
| IMPROVEMENTS: | Footprint Area: | ±26,143 SF |
| | Office Area: | ± 747 SF |
| | Warehouse Area: | ±25,396 SF |
| | Heat: | Office Area: Forced air heat |
| | | Warehouse Area: Gas unit heaters in north whse; radiant gas heat in southeast whse |
| | Grade-level Overhead Doors: | Seven (7) grade loading doors |
| | Dock Loading: | One (1) dock loading door |
| | Clearance Height: | 12'-31'2" |
| | Sewer & Water: | City of Spokane, connection record dated 3/29/1957 |
| | Construction Type: | South Bldg: wood frame, siding & concrete block; North Bldg: steel frame, metal siding |
| LEASE INFO: | Age: | 1950-1952 |
| | Power: | 400 amp 240 v, 3 phase |
| LEASE INFO: | Leased to Valley Ford Metal Crafters through January 31, 2028 for \$9,274.39/Month/NNN; (1) 5-year Option | |
| SALE PRICE: | \$1,850,000.00 | |

**KIEMLE
HAGOOD**

Mark Lucas, SIOR |

509.755.7524

mlucas@kiemlehagood.com

Tracy Lucas |

509.755.7558

tracyl@kiemlehagood.com

All information herein is furnished by the owner and believed to be complete and correct. The Agent, however, cannot be responsible for changes, errors, omissions or withdrawals of this offering without notice. The above information is from sources deemed reliable but should be verified by parties that could be adversely affected by any statements or information. This is not an offering of sub-agency, with commission splits to be determined. 01/06/26/tp J:\BROKERS\LUCAS DOCS\FLYERS\Sycamore N 414.PUB



OFFICE & WAREHOUSE | 414 N. Sycamore St., Spokane, WA 99202

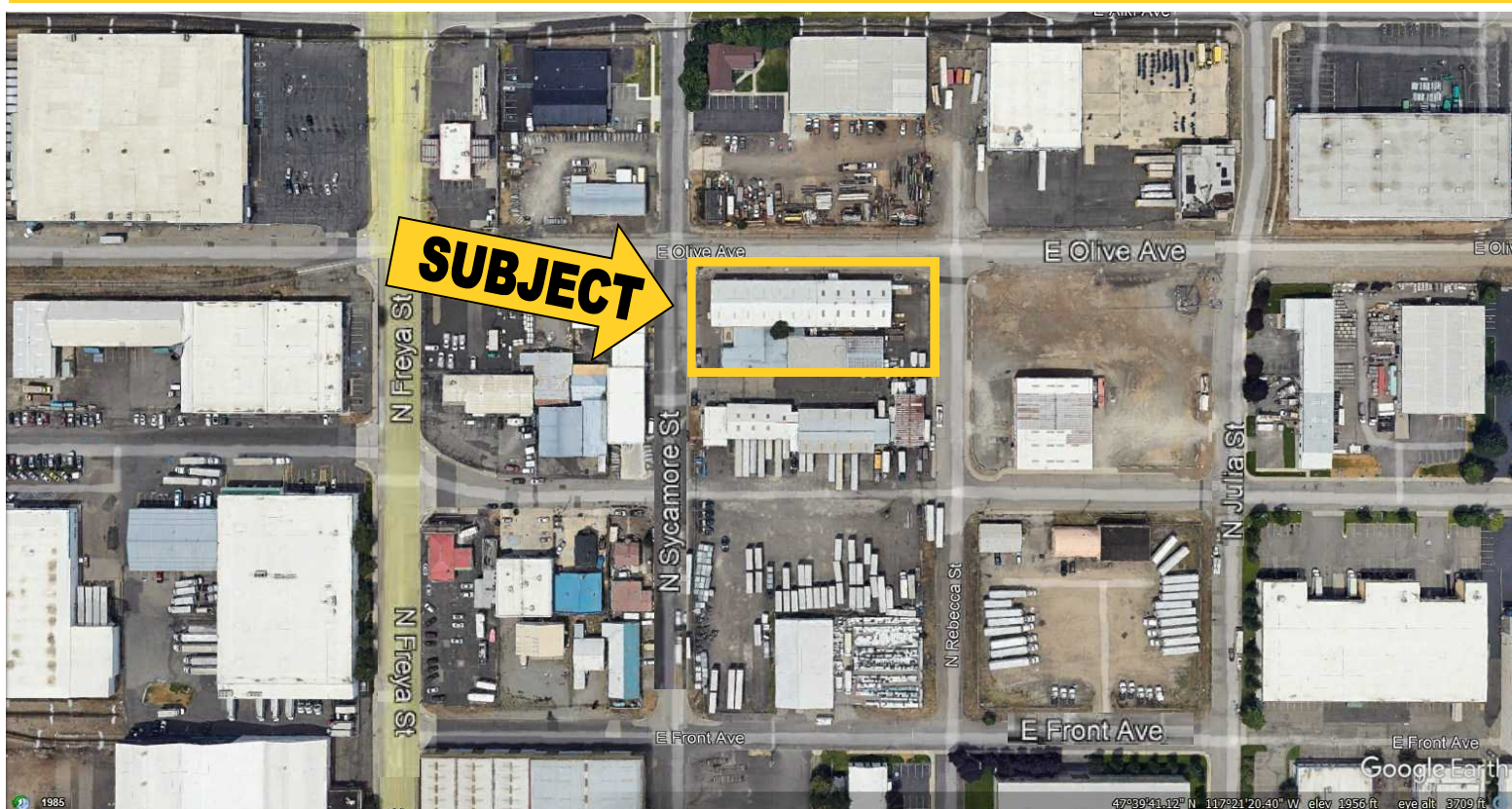

Mark Lucas, SIOR | 509.755.7524 or mlucas@kiemlehagood.com

Tracy Lucas | 509.755.7558 or tracyl@kiemlehagood.com

Kiemle Hagood respects the intellectual property of others: If you believe the copyright in your work has been violated though this Website, please contact our office for notice of claims of copyright infringement. For your complaint to be valid under the Digital Millennium Copyright Act of 1998 (DMCA), you must provide the following information when providing notice of the claimed copyright infringement: Identify the material on the Website that you believe infringes your work, with enough detail so that we may locate it on the Website; provide your address, telephone number and email address; provide a statement that you have a good faith belief that the disputed use is not authorized by the copyright owner, its agent, or the law; provide a statement that the information in the notification is accurate, and under penalty of perjury, that the complaining party is authorized to act on behalf of owner of an exclusive right that is allegedly infringed; provide your physical or electronic signature. Upon receiving your complaint, Kiemle Hagood will, upon review, remove content that you believe infringes your copyright if the complaint is found valid.

**KIEMLE
HAGOOD**

FLOOR PLAN

414 N. Sycamore St., Spokane, WA 99202

THIS DRAWING IS FOR CONVENIENCE ONLY. ALL CRITICAL MEASUREMENTS SHOULD BE VERIFIED BY PURCHASER OR LESSEE. ALL RIGHTS RESERVED. NO PART OF THIS DOCUMENT MAY BE REPRODUCED IN ANY FORM OR BY ANY MEANS WITHOUT WRITTEN PERMISSION FROM MARK & TRACY LUCAS.

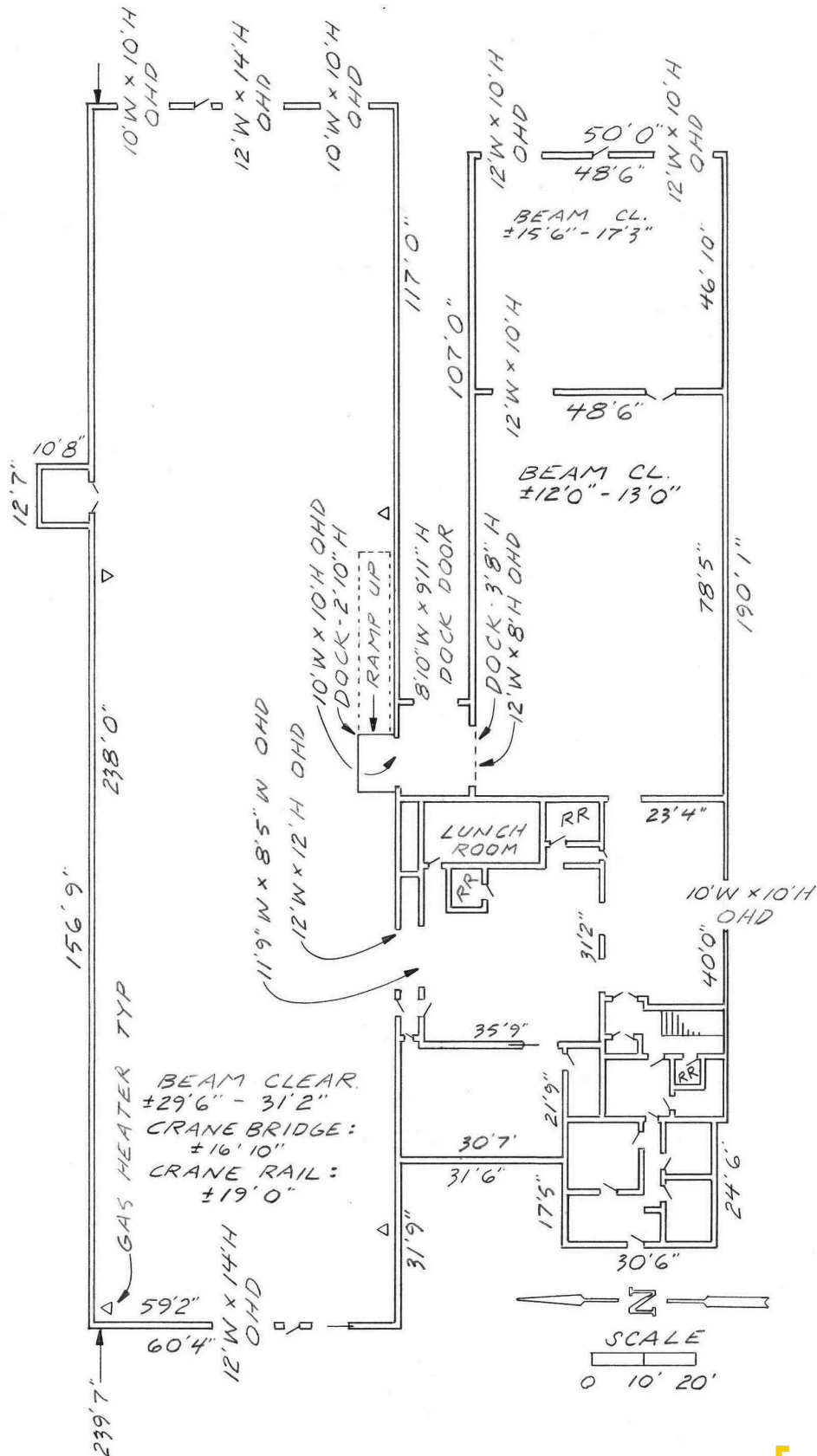

Mark Lucas, SIOR | 509.755.7524 or mlucas@kiemlehaood.com

Tracy Lucas | 509.755.7558 or tracyl@kiemlehaood.com

KIEMLE
HAGOOD

Neighboring Parcels FOR SALE

414 N. Sycamore St., Spokane WA 99202



1 408 N. Sycamore

- Building Area: ± 12,565 SF
- Site Size: ± 97,500 SF
- Parcel: 35154.1706, .1705, .2801-.2804
- Sale Price: \$1,900,000
- Leased to ABF Freight through November 30, 2028



2 3719 E. Front

- Building Area: ± 9,044 SF
- Site Size: ± 25,000 SF
- Parcel: 35154.2805
- Sale Price: \$575,000
- Leased to Appliance Parts & Recycling through May 31, 2029



3 3804 E. Ferry

- Building Area: ± 7,377 SF
- Site Size: ± 75,000 SF
- Parcel: 35154.2701
- Sale Price: \$1,150,000
- Leased to United Natural Foods through March 31, 2027