

**FOR SALE | MULTI-FAMILY DEVELOPMENT OPPORTUNITY**

**TAHOMA VALLEY GOLF COURSE**

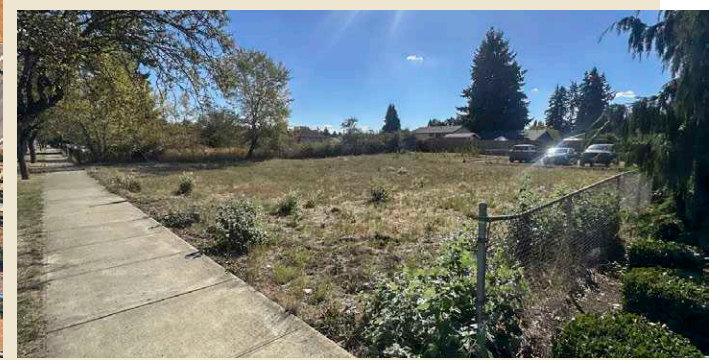

411 YELM AVE W, YELM, WA 98597

**PROPERTY OVERVIEW**

This high-traffic property offers excellent visibility in a fast-growing area, making it a strategic location for investment.

The site benefits from versatile Central Business District (CBD) zoning, which accommodates a variety of potential uses, including retail, services, and multi-family developments. To facilitate future projects, the property features water and sewer connections on-site, with power and gas access available at the street.

Parcel: 75300400300

**LAND: 0.28 AC**

**SALE: \$285,000**

**ZONING: CBD**

**CBA # 43440929**

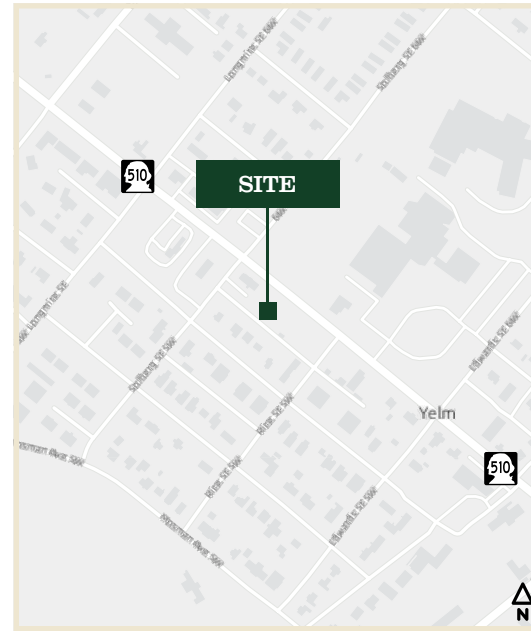

**Max Stottlemyre**

COMMERCIAL BROKER

360.701.5756

maxstottlemyre@greenecommercial.com

The information contained herein has been obtained from sources believed to be reliable. However, we make no guarantees, warranties, or representations as to the completeness or accuracy thereof. All information is submitted subject to errors, omissions, change of price, rental or other conditions, prior sale, lease or financing, or withdrawal without notice. Any projections, opinions, assumptions, or estimates used are for example only and do not represent the current or future performance of the property. Prospective buyers or tenants should conduct their own independent investigation and rely on those results.



**360.528.4167**

**greenecommercial.com**