

11th St. Professional Bldg.

100 NE 11th St
East Wenatchee, WA.

FOR SALE



- 3,140 total Bldg. SF.
- Fully Leased
- Investment Property

CENTER INVESTMENTS INC.

O: (509) 884-6381 www.centerinvestmentsinc.com



professional services
CENTRAL BUSINESS DISTRICT
interior improvements

Offering SUMMARY

List Price	- \$495,000
\$/SF. (Bldg.)	- \$162.82
Occupancy	- 100%
Gross Income	- \$40,225
Average Rent	- \$13.00/SF/Yr.
Market Rate	- \$15.00/SF/Yr.

Chau Birks
President
chaun@ncw-commercial.com

Chad Hamilton
VP Operations & Leasing
chad@ncw-commercial.com

CENTER INVESTMENTS INC.

O: (509) 884-6381 www.centerinvestmentsinc.com



Property SUMMARY

Parcel - #07600300002

LAND - .23 Acres

BLDG. - 3,140 SF.

ACCESS - curb cut from 11th Street NE

LOCATION - East Wenatchee, Douglas Co.

ZONING - Central Business District



GENERAL DESCRIPTION - Two story, three tenant building consisting of 3,140 SF. 100% leased. Originally built in 1944, extensively renovated in 1985 with recent and ongoing updates to interior spaces. 30+ year history as a viable commercial asset with current tenants that include a salon & spa services, barber shop and counseling services. Located just north of Downtown East Wenatchee with views of the Columbia River and Cascade Foothills, convenient access to SR 28 and the Apple Capital Loop Trail.

100 11th Street NE
East Wenatchee, WA.

Parcel Outline



100 11th Street NE
East Wenatchee, WA.

Floor Plan

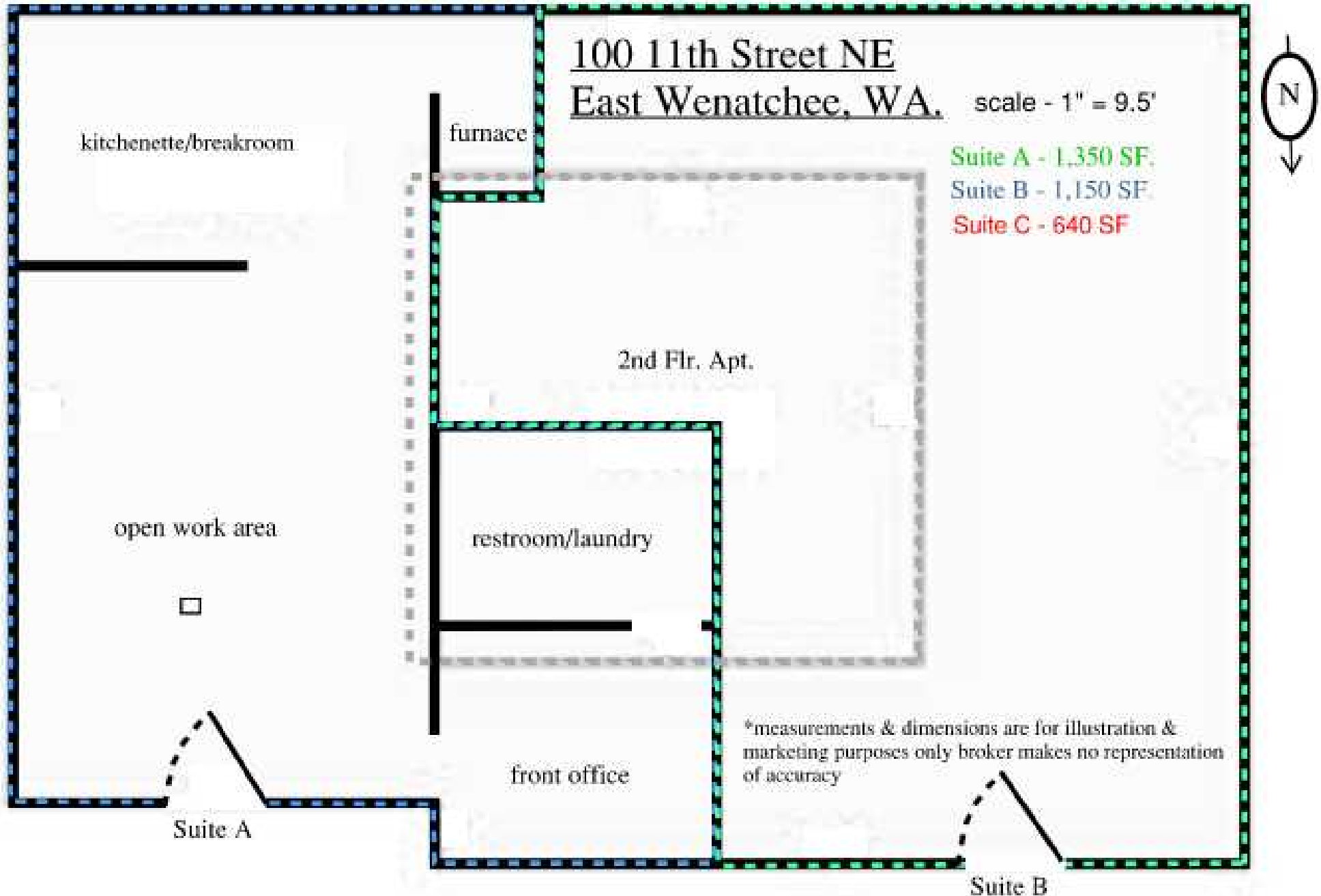

East Wenatchee - area businesses



Downtown East Wenatchee

Baker Street

9th St. NE

Alvin Ct.

11th St. NE



Valley Mall Parkway

SR

SR 28

Apple Capital Loop Trail

Columbia River

