

FOR SALE

RETAIL/OFFICE SPACE

2950 EASTLAKE AVENUE E, SUITE 4 | SEATTLE, WA 98102



CAMERON
KENT

206.838.7737
ckent@ewingandclark.com

EWING & CLARK
INCORPORATED

OFFERING SUMMARY

2950 EASTLAKE AVENUE E, STE 4 | SEATTLE, WA 98102



PROPERTY DETAILS

- Retail/Office Commercial Condo for lease/sale at the Ruby Condominiums. It is a Fully-plumbed modern suite built in 2009 that sits below 4-stories of 52 units.
- This unit includes 3 private rooms, a bathroom, and an open main area.
- Currently a Salon
- 1,027 Square Feet
- Price: \$625,000
- \$505 mo HOA dues (Includes water, sewer, garbage)
- One dedicated parking stall (premium)
- Please call brokers to arrange or tour or for further information.

PHOTOS

2950 EASTLAKE AVENUE E, STE 4 | SEATTLE, WA 98102



FLOOR PLAN

2950 EASTLAKE AVENUE E, STE 4 | SEATTLE, WA 98102

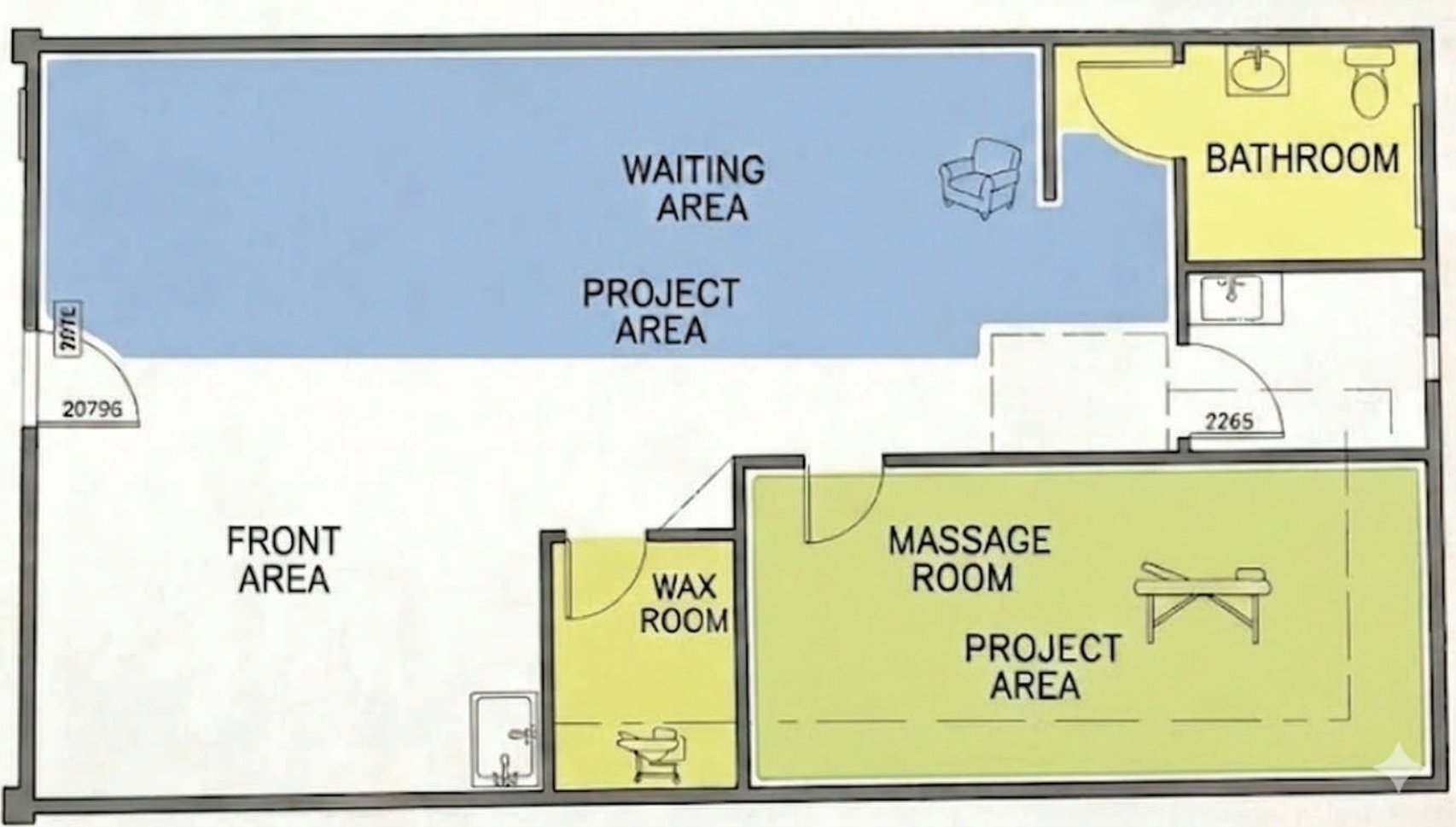

DEMOGRAPHICS

2950 EASTLAKE AVENUE E, STE 4 | SEATTLE, WA 98102



44,919

DAYTIME
POPULATION



\$525M

ANNUAL CONSUMER
EXPENDITURE
(NON-RETAIL)



33,498

POPULATION



14,984

HOUSEHOLDS



\$139,352

AVERAGE HOUSEHOLD
INCOME

*All information is based off of 1 mile radius in 2024.

PROPERTY MAP

2950 EASTLAKE AVENUE E, STE 4 | SEATTLE, WA 98102

