

## Bethel Avenue Development

Retail: Mixed Use

2153 Bethel Avenue SE, Port Orchard, WA, 98366

Prepared on March 13, 2024

0

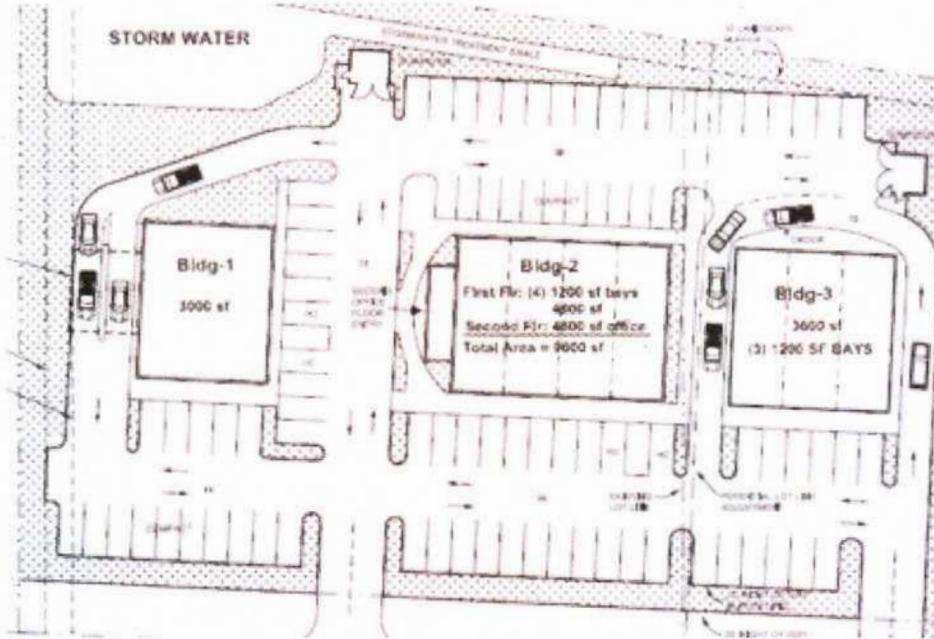

### Property Features

#### Location Details

Address	2153 Bethel Avenue SE, Port Orchard, ...	Parcels	362401-2-015-2004
Zoning	CMU	In Opportunity Zone	Yes
Submarket	CBA Port Orchard	Name	Bethel Avenue Development
County	Kitsap		

#### Building Details

Sub Type	Mixed Use	Parking Spaces	85
Building Status	Under Construction	Parking Ratio	5.1/1000
Building Size	16,800 SF	Retail Space	11,400 SF
Land Size	1.41 Acres / 61,420 SF	Office Space	5,400 SF
Number of Buildings	1	In Opportunity Zone	Yes
Number of Floors	2	Rentable Space	16,600 SF
Year Built	2008	Rail Service	No
Occupancy Type	Single Tenant		

This property is not currently listed for sale/lease.

### Contact

 **Gary Anderson**  
360-373-2343  
garee1776@aol.com

G. Anderson Group, LLC

**ADDRESS:**

2153 Bethel Avenue SE  
Port Orchard, WA

**AVAILABLE SPACE:**

5,400+/- SF of Office  
11,400+/- SF of Retail  
(can be demised)



- ◆ Retail buildings 1 & 3 available for lease or on ground lease terms
- ◆ Building 2 retail with second level office
- ◆ Drive thru available
- ◆ Excellent visibility and access from Bethel Road

2008/2009

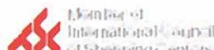

# BETHEL AVENUE DEVELOPMENT

