

14205 BUILDING

Stabilized High-Image Office Building With 3.88 Year WALT

CONFIDENTIAL OFFERING MEMORANDUM

14205 SE 36th St, Bellevue, WA 98006





OFFERED EXCLUSIVELY BY

RJ VARA

Senior Vice President
206.584.6195
rvara@northmarq.com
License: WA 135292

KEVIN ADATTO

License: WA 21038208

DEBT & EQUITY

STUART OSWALD

Managing Director
425.974.1005
soswald@northmarq.com

JACK BELL

Associate Producer
425.974.1058
jbell@northmarq.com

Northmarq

130 Nickerson St, Suite 200
Seattle, WA 98109

northmarq.com

TABLE OF CONTENTS

Section 1: Executive Overview	3
Section 2: Property Summary	11
Section 3: Financial Summary	17
Section 4: Market Overview	23

CONFIDENTIALITY AND RESTRICTED USE AGREEMENT

This Confidential Offering Memorandum ("COM") is provided by Northmarq, solely for your consideration of the opportunity to acquire the commercial property described herein (the "Property"). This COM may be used only as stated herein and shall not be used for any other purpose, or in any other manner, without prior written authorization and consent of Northmarq.

This COM does not constitute or pertain to an offer of a security or an offer of any investment contract. This COM contains descriptive materials, financial information and other data compiled by Northmarq for the convenience of parties who may be interested in the Property. Such information is not all inclusive and is not represented to include all information that may be material to an evaluation of the acquisition opportunity presented. Northmarq has not independently verified any of the information contained herein and makes no representations or warranties of any kind concerning the accuracy or completeness thereof. All summaries and discussions of documentation and/or financial information contained herein are qualified in their entirety by reference to the actual documents and/or financial statements, which upon request may be made available. An interested party must conduct its own independent investigation and verification of any information the party deems material to consideration of the opportunity, or otherwise appropriate, without reliance upon Northmarq.

The Property may be financed or withdrawn from the market without notice, and its owner(s) reserve(s) the right to negotiate with any number of interested parties at any time. The Property is offered and sold by its owner(s) as is, where is, and with all faults, without representation or warranty of any kind except for any customary warranties of title.

BY ACCEPTING THIS COM, YOU AGREE THAT: (1) all information contained herein, and all other information you have received or may hereafter receive from Northmarq relating to the Property, whether oral, written or in any other form (collectively, the "Information"), is strictly confidential; (2) you will not copy or reproduce, and claim as your own without attribution to Northmarq, all or any part of this COM or the Information; (3) upon request by Northmarq at any time, you will return and/or certify your complete destruction of all copies of this COM and the Information; (4) for yourself and all your affiliates, officers, employees, representatives, agents and principals, you hereby release and agree to indemnify and hold harmless Northmarq all of its affiliates, officers, employees, representatives, agents and principals, from and with respect to any and all claims and liabilities arising from or related to the receipt or use of this COM and/or any other Information concerning the Property; (5) you will not provide this COM or any of the Information to any other party unless you first obtain such party's acceptance and approval of all terms, conditions, limitations and agreements set forth herein, as being applicable to such party as well as to you; and (6) monetary damages alone will not be an adequate remedy for a violation of these terms and that Northmarq shall be entitled to equitable relief, including, but not limited to, injunctive relief and specific performance, in connection with such a violation and shall not be required to post a bond when obtaining such relief.



SECTION ONE

Executive Overview



DISTANCE TO I-90 ON RAMP
0.9 MILE | 5 MINUTES

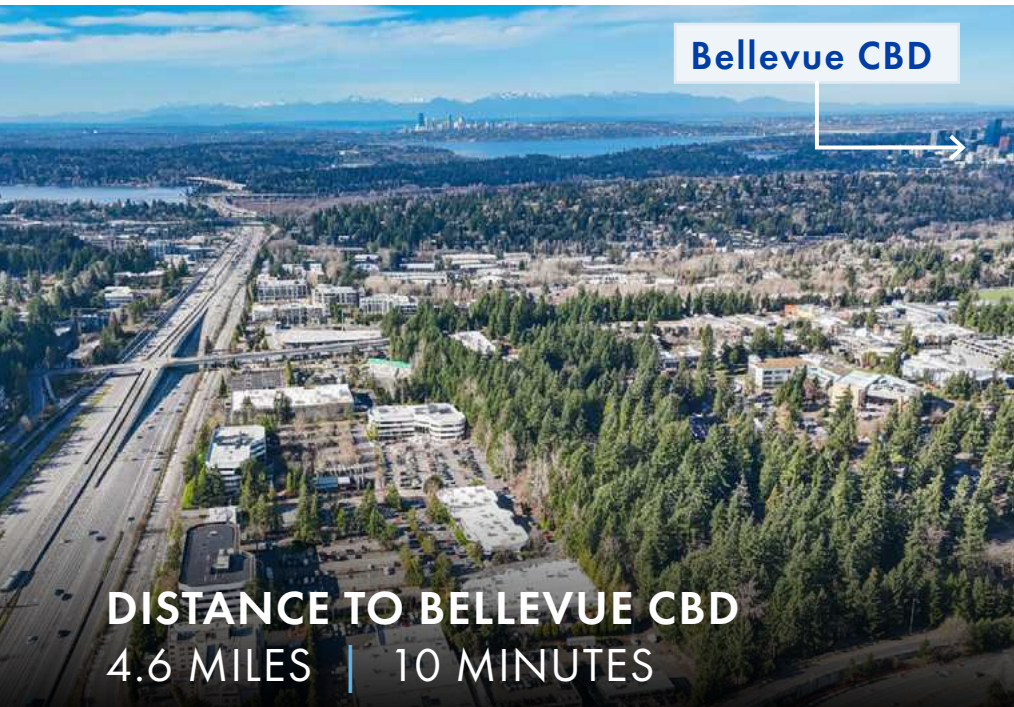

Bellevue CBD

DISTANCE TO BELLEVUE CBD
4.6 MILES | 10 MINUTES

Investment Overview

The 14205 Building presents a premier investment opportunity to acquire a high-image, fully stabilized office asset in the heart of Bellevue's desirable I-90 corridor.

Comprising 41,577 rentable square feet, the property is 100% occupied by a diverse mix of seven professional and medical tenants, providing immediate and dependable cash flow. With a staggered lease expiration schedule and a core anchor tenant recently extended through 2033, the asset offers rare income durability in one of the Pacific Northwest's most resilient submarkets.

The property has benefited from recent capital improvements designed to minimize near-term expenditure and preserve its competitive Class A suburban feel. Situated at the strategic junction of I-90 and I-405, the building serves as a mission-critical location for tenants seeking proximity to both the Seattle and Bellevue central business districts while offering the convenience and accessibility of the Eastgate area.









PRICE: \$15,425,000

PRICE PER SF: \$371.00

YEAR 1 CAP RATE: 7.57%

WALT: 3.88 Years

The Marketplace at Factoria

 NORDSTROM rack	 TARGET	 T&T Supermarket	 ULTA BEAUTY
 DIMSUM factory	 Novilhos BRAZILIAN STEAKHOUSE	 Just Poke	 Panera BREAD

T Mobile
Headquarters

**14205
BUILDING**

Seattle CBD
9.8 mi | 12 min

Bellevue CBD
4.6 mi | 10 min



**South Bellevue Link
Light Rail Station**



**Eastgate Park
& Ride**

I-90 / I-405 Interchange
1.2 mi | 6 min

142ND PL SE



**Future Issaquah Link
(Line 4)**



EXCEPTIONAL OCCUPANCY & RETENTION

The property is fully leased to seven tenants, including medical and professional service firms with an average tenure of nearly 14 years.



ANCHOR TENANT COMMITMENT

Premier Office Centers, which comprises 35% of the Net Operating Income (NOI), recently executed an early lease extension through July 2033, providing long-term structural stability.



INFLATION-HEDGED LEASES

All in-place leases are NNN with contractual annual rent increases of at least 3.00%, offering a natural hedge against inflation.



PREMIER CONNECTIVITY

Located at the primary interchange of I-90 and I-405, the property provides seamless transit to Seattle (9.8 miles) and Bellevue CBD (4.6 miles).



PROXIMITY TO TALENT & AMENITIES

Across I-90 from Bellevue College and the Eastgate Park & Ride, the building is surrounded by high-density professional and student populations that drive long-term demand.



SUPPLY-CONSTRAINED SUBMARKET

A decrease in competing product within the I-90 corridor due to redevelopment, coupled with high barriers to entry, supports long-term asset value and rental growth.

Featured Tenant



OCCUPIED SF: 16,260 SF (39% of RBA)
LEASE EXPIRATION: July 31, 2033



Founded in 2002, Premier Workspaces is one of the largest privately held flexible workspace operators in the United States. Over its **24-year history**, the company has grown to manage over **90 locations** across the country, totaling approximately **2 million square feet** of office space. Unlike venture-backed competitors, Premier has maintained a long-term, stable growth model focused on executive suites and professional service firms, making them a “sticky” anchor for suburban office assets.

24+ YEARS OF OPERATIONAL HISTORY

Established stability in the flexible workspace sector since 2002.

90+ LOCATIONS NATIONWIDE

Significant national footprint providing diversified revenue streams.

LONG-TERM COMMITMENT

Recent early extension secures 35% of building NOI through 2033.

Featured Tenant

Optum

LOGISTICS HEALTH, INC.

OCCUPIED SF: 5,976 SF (14.4% of RBA)

LEASE EXPIRATION: June 30, 2027



Logistics Health, Inc. (LHI) is a wholly-owned subsidiary of **Optum**, which is the health services arm of UnitedHealth Group (NYSE: UNH). As a **Fortune 5 company** (#4 in 2024), UnitedHealth Group is a global leader in healthcare, reporting **\$371.6 billion in revenue** for 2023. Optum alone employs over 310,000 people worldwide and provides technology, pharmacy, and clinical services to nearly 130 million individual consumers. The presence of an Optum-affiliated entity provides significant “medical-credit” stability to the asset.

INVESTMENT GRADE CREDIT

Parent company UnitedHealth Group holds an A+ (S&P) credit rating.

FORTUNE 5 BACKING

Subsidiary of one of the world’s largest healthcare companies by revenue (\$371B+).

300,000+ EMPLOYEES

Part of a massive global workforce driving medical and logistical innovation.





SECTION TWO

Property Summary

14205 BUILDING

14205 SE 36th St,
Bellevue, WA 98006

Parcel Number	102405-9084
Year Built	1990
Rentable Building Area	41,577 SF
Land Area	94,525 SF (2.17 Acres)
Zoning	Office and Limited Business 2 (OLB2)
Occupancy	100%



153
PARKING
STALLS

SE 36TH ST

Stacking Plan

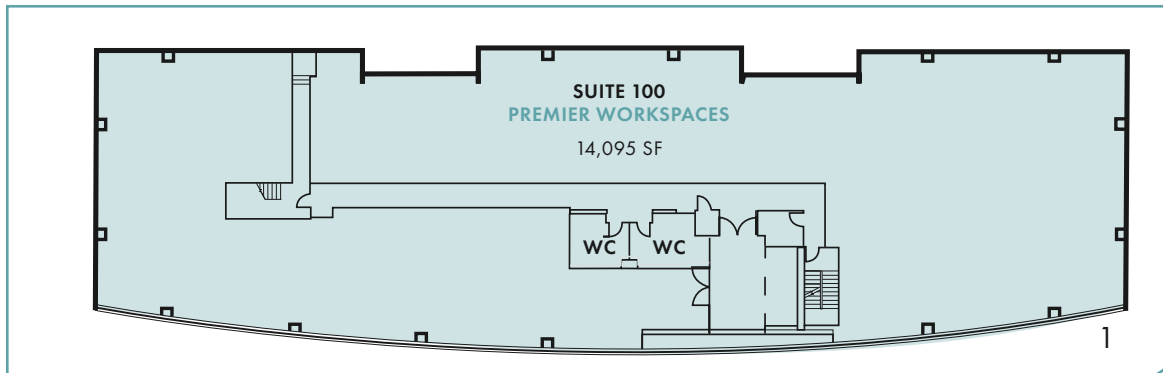
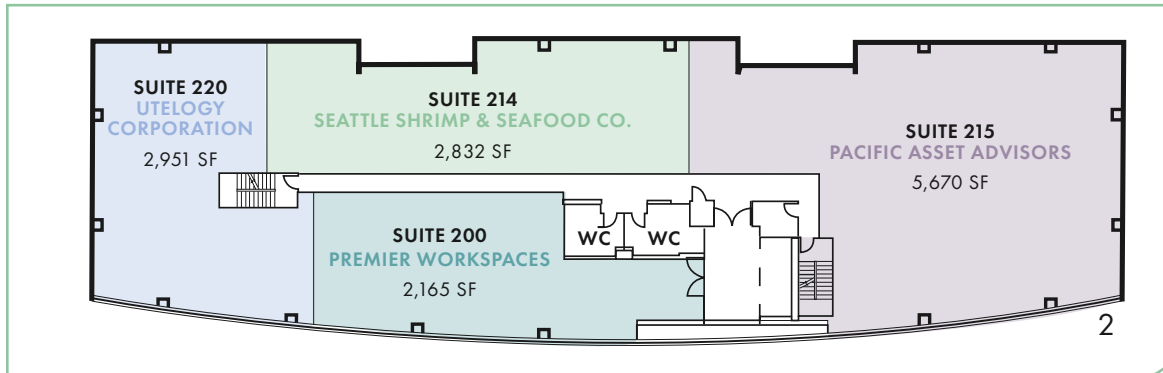
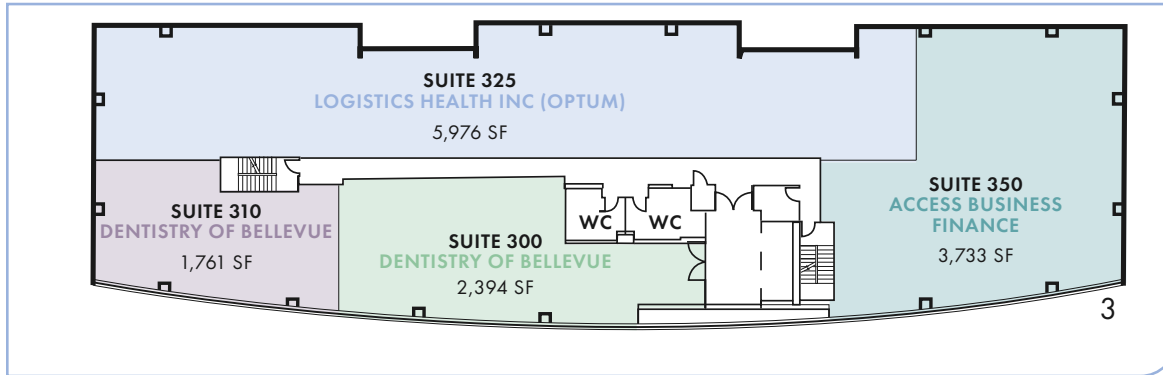

PARKING STALLS
153
(3.68/1,000 SF)

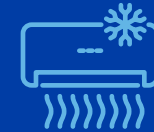

HVAC

One Roof Mounted Air Conditioning Unit



ELEVATOR

Two Elevators



PACIFIC ASSET ADVISORS



ELEVATOR LOBBY



PACIFIC ASSET ADVISORS



PREMIER WORKSPACES



UTEOLOGY



DENTISTRY OF BELLEVUE



DENTISTRY OF BELLEVUE



PREMIER WORKSPACES





SECTION THREE

Financial Summary

Rent Roll

AS OF **AUGUST 2026**

Tenant Name	Suite	Square Feet	Lease Comm.	Lease Exp.	Annual Rent/SF	Base Rent/Mo.	Base Rent/Yr.	Pro Forma Rent/Yr	Rent Increase	Lease Type
Premier Workspaces	100/200	16,260 SF	6/20/90	7/31/33	\$25.88	\$35,067	\$420,809	\$455,280	8.19%	NNN
Seattle Shrimp & Seafood Co.	214	2,832 SF	8/1/21	10/31/27	\$30.39	\$7,172	\$86,064	\$91,301	2.99%	NNN
Pacific Asset Advisors	215	5,670 SF	3/1/17	12/31/27	\$30.60	\$14,459	\$173,502	\$178,662	2.97%	NNN
Utology Corporation	220	2,951 SF	7/1/22	8/31/26	\$33.00	\$8,115	\$97,383	\$100,305	3.00%	NNN
Dentistry Of Bellevue	300/310	4,155 SF	12/1/16	12/31/31	\$31.27	\$10,828	\$129,933	\$134,088	3.20%	NNN
Logistics Health Inc (Optum)	325	5,976 SF	4/1/21	6/30/27	\$30.00	\$14,940	\$179,280	\$191,232	6.67%	NNN
Access Business Finance	350	3,733 SF	5/1/96	8/31/29	\$25.00	\$7,777	\$93,325	\$96,125	3.00%	NNN
Total		41,577 SF			\$28.39 (avg)	\$98,358	\$1,180,296	\$1,246,992		



Operating Statement

FOR THE PERIOD 8/1/2026 - 7/31/2027

Income	Current		Per SF	
Scheduled Base Rental Income	1,182,873		28.45	
CAM	367,279		8.83	
Insurance	16,790		0.40	
Real Estate Taxes	92,597		2.23	
Management Fees	53,229		1.28	
Total Reimbursement Income	\$529,895	99.2%	\$12.74	
Other Income - Amortized Capital Expenditures	78,279		1.88	
Potential Gross Revenue	1,791,047		43.08	
General Vacancy	(89,552)	5.0%	(2.15)	[1]
Effective Gross Revenue	\$1,701,495		\$40.92	

Operating Expenses	Current		Per SF	
Electric & Gas	106,214		2.55	[2]
Garbage/Recycling	8,899		0.21	[2]
Water/Sewer	20,559		0.49	[2]
Janitorial	81,600		1.96	[3]
Day Port	11,880		0.29	[3]
Parking Lot Maintenance & Snow Removal	2,369		0.06	[2]
Pest Control	1,041		0.03	[3]
Elevator	10,400		0.25	[3]
Repairs & Maintenance	64,236		1.55	[4]
Landscaping	17,357		0.42	[3]
HVAC	23,000		0.55	[3]
Fire & Life Safety	11,780		0.28	[2]
Exterior Cleaning	7,945		0.19	[3] [5]
Insurance	16,790		0.40	[2]
Real Estate Taxes	92,597		2.23	[6]
Management Fee	53,229	4.5%	1.28	[7]
Reserves	4,282		0.10	[8]
Total Expenses	\$534,179		\$12.85	
Expenses as % of EGR	31.4%			
Net Operating Income	\$1,167,316		\$28.08	

[1] Based upon Lender Underwriting Standards

[2] Based upon 2025 Actuals with 3% Growth Rate

[3] Based upon vendor contract

[4] Based upon Market Assumption of \$1.50/ft - 2025 Actuals & 2026

Budget were \$1.71/ft. (Exterior & Interior, Plumbing, HVAC, Roof, Elevator, Fire Alarm, Lighting, Facilities)

[5] Encompasses Pressure Washing, Window Cleaning, Sweeping

[6] Based on 85% of the Purchase Price at current millage rates

[7] Based on Market Management Fee - Does not include Asset Management or Construction Management

[8] Based on Market General Reserve of \$0.25/ft

Amortization Schedules

Carpet - Over 5 Years	
Cost	\$33,700.51
Year 1 - 2023	\$6,740.10
Year 2 - 2024	\$6,740.10
Year 3 - 2025	\$6,740.10
Year 4 - 2026	\$6,740.10
Year 5 - 2027	\$6,740.10

Amortize 3 Compressors HVAC - Over 5 Years	
Cost:	\$30,203.53
Year 1 - 2022	\$6,040.71
Year 2 - 2023	\$6,040.71
Year 3 - 2024	\$6,040.71
Year 4 - 2025	\$6,040.71
Year 5 - 2026	\$6,040.71

Amortize Interior LED Upgrade Interior Lighting - Over 6 Years	
Cost:	\$40,221.88
Year 1 - 2024	\$6,703.65
Year 2 - 2025	\$6,703.65
Year 3 - 2026	\$6,703.65
Year 4 - 2027	\$6,703.65
Year 5 - 2028	\$6,703.65
Year 6 - 2029	\$6,703.65

New RTU & Controls Upgrade HVAC - Over 10 Years	
Cost:	\$58,794.00
Year 1 - 2025	\$58,794.70
Year 2 - 2026	\$58,794.70
Year 3 - 2027	\$58,794.70
Year 4 - 2028	\$58,794.70
Year 5 - 2029	\$58,794.70
Year 6 - 2030	\$58,794.70
Year 7 - 2031	\$58,794.70
Year 8 - 2032	\$58,794.70
Year 9 - 2033	\$58,794.70
Year 10 - 2034	\$58,794.70

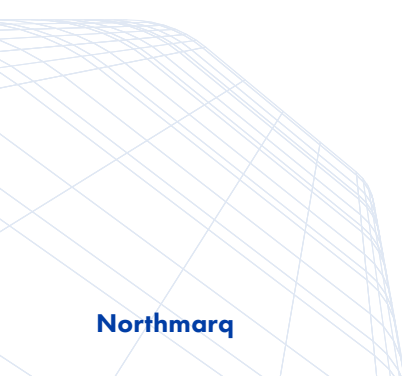



14205 BUILDING

Price	\$15,425,000
Year 1 Cap Rate	7.57%
Occupancy	100%
WALT	4 Years, 2 Months, 21 Days
Rentable Building Area	41,577 SF
Price Per SF	\$371.00
Year Built/Renovated	1990/2010





SECTION FOUR

Market Overview

The Eastgate Discount

The 14205 Building offers a high-image, professional environment at a price point fundamentally more sustainable than the Bellevue CBD. By positioning within the I-90 Corridor, landlords can capture regional demand while providing tenants with a massive basis advantage.

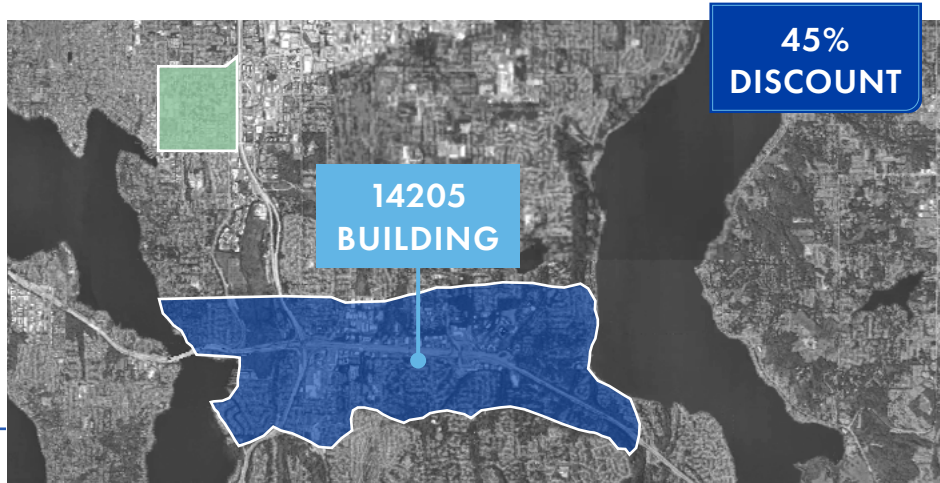

	I-90 Submarket	Bellevue CBD
Direct Asking Rents	\$35.00 – \$45.00 PSF	\$65.00 – \$80.00 PSF
Under Construction	0 SF	±1,400,000 SF
Total Inventory	±5,500,000 SF	±13,500,000 SF

THE BOTTOM LINE

The I-90 submarket provides a **±45% rent discount** compared to the Bellevue CBD, saving a 10,000 SF tenant roughly **\$300k–\$350k annually**. This significant basis advantage allows the 14205 Building to offer a high-image, professional environment at a sustainable price point that attracts a broad range of regional businesses.

Strategic Conclusions

MASSIVE COST SAVINGS

The I-90 submarket offers a ±45% discount on rents compared to the CBD. For a 10,000 SF tenant, this equates to \$300,000–\$350,000 in annual savings.

SUPPLY INSULATION

With 0 SF currently under construction, the I-90 corridor is protected from the downward pricing pressure and “flight-to-quality” competition impacting the CBD’s 1.4M SF pipeline.

PREDICTABLE STABILITY

Investors are acquiring a “finished” landscape. The lack of new supply ensures a stabilized supply-demand balance that won’t be disrupted by major new tower deliveries.

TENANT RETENTION

The corridor’s lower density and high accessibility (parking and ease of access) are increasingly attractive to professional and medical services as CBD density rises.

Unrivaled Connectivity in the Heart of Factoria

Located at the I-90 and I-405 nexus, the 14205 Building offers a lifestyle of convenience. Enjoy immediate access to over 50 transit, dining, and retail destinations—all within minutes of your office.

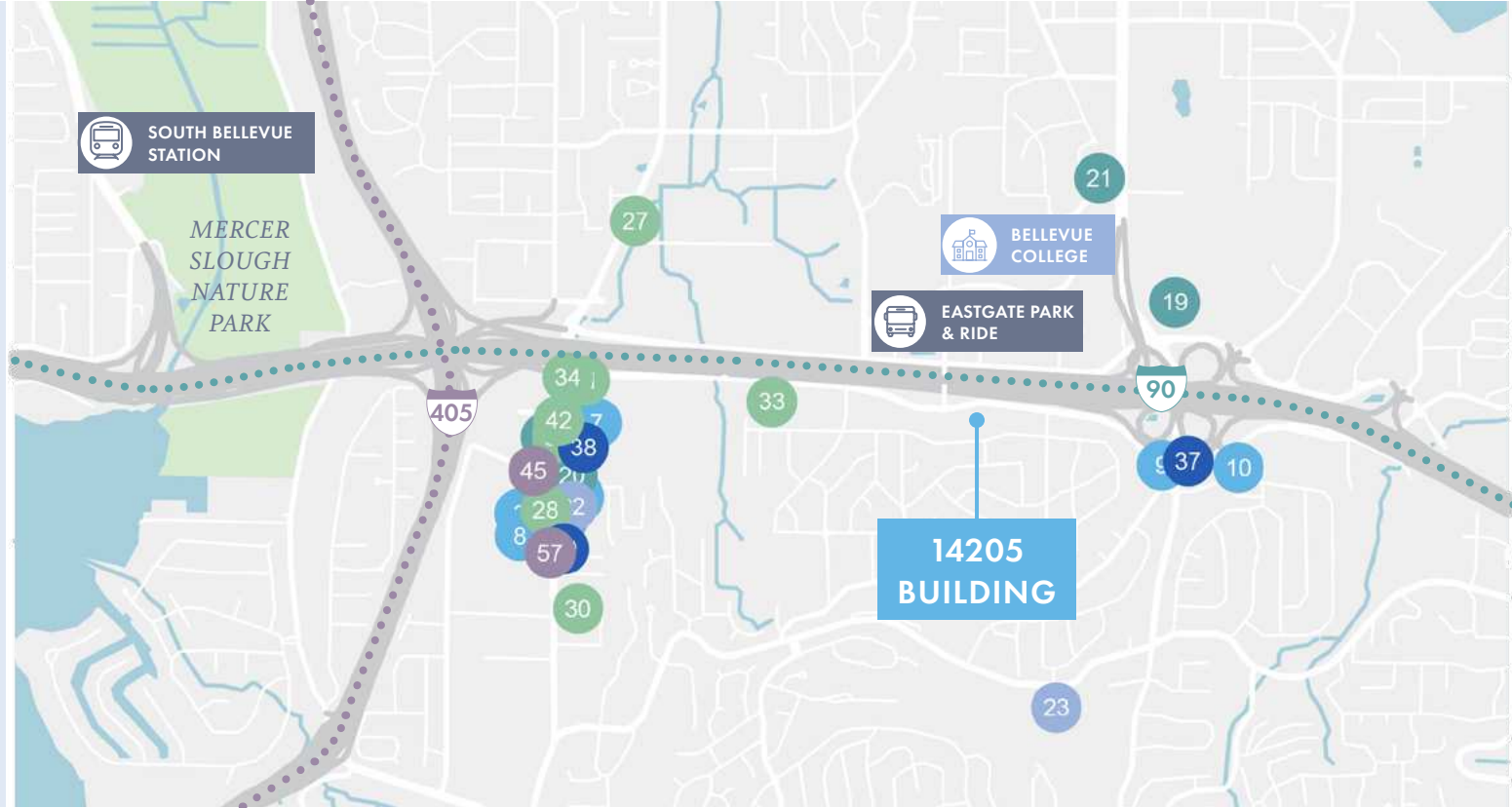

RESTAURANTS

1. Applebee's Grill + Bar
2. Red Robin Gourmet Burgers
3. Taco Time NW
4. Mustard Seed Grill & Pub
5. Kura Revolving Sushi Bar
6. Novilhos Brazilian Steakhouse
7. Daeho Bellevue
8. Kuro Sushi
9. Taqueria Los Tetillas
10. Lil' Jon Restaurant & Lounge
11. Shaoshan Ricenoodle
12. Dim Sum Factory Co.
13. Arepa Venezuelan Kitchen
14. Burger King

COFFEE & BAKED GOODS

15. Starbucks
16. Woods Coffee
17. Last Frontier Coffee
18. Regent Cakes & Bakery
19. 5 Stones Coffee Co
20. Over the Rainbow Tea Bar

FITNESS

21. South Bellevue Community Center
22. LA Fitness
23. 24 Hour Fitness
24. Compound Strength & Performance

LIFESTYLE & SERVICES

25. The Herbal Nail Spa
26. T&T Supermarket
27. Factoria Eye Clinic
28. Gene Juarez Salon & Spa
29. Great Clips
30. Arte Hair Studio
31. Public Storage
32. Monster Mini Golf
33. Funtastic Playtorium

BANKS

34. Chase Bank
35. BECU Credit Union
36. Bank of America
37. Wells Fargo Bank
38. U.S. Bank
39. KeyBank

SHOPPING

40. The Marketplace at Factoria
41. Target
42. Walmart Supercenter
43. Nordstrom Rack
44. T.J. Maxx
45. Ulta Beauty
46. Old Navy
47. DSW Designer Shoe Warehouse
48. Restoration Hardware Outlet
49. Famous Footwear
50. Big 5 Sporting Goods
51. Lakeshore Learning Store
52. Kennelly Keys Music
53. Mighty Moose Comics
54. Olsen & Sons Fine Jewelry
55. Pet Supplies Plus

TRANSPORTATION

-  **Bellevue College**
0.9 mi | 5 min
-  **I-90 Access**
0.9 mi | 5 min
-  **I-405 Access**
1.2 mi | 6 min
-  **South Bellevue Station**
2.4 mi | 9 min
-  **Eastgate Park & Ride**
0.6 mi | 4 min

Nearby Multifamily/Townhome Developments



STRATOS BY INTRACORP

Located just steps from the asset, this redevelopment of the former Department of Ecology building replaces a 61,000 SF office with **67 high-end for-sale townhomes**.



TAYLOR MORRISON

This project redevelops the former 4-acre Verizon office site into **77 luxury townhomes**. This shift from office to high-density residential significantly increases the “live-work” appeal for professional tenants in the 14205 Building.



POLARIS AT EASTGATE

A massive high-density residential project located less than a mile from the 14205 Building. It will provide **360 units of housing**, directly supporting the local “live-work” ecosystem.

Stratos by Intracorp (Former DOE Building)	Townhomes	67 Units	Under Construction	Q3 2026
Taylor Morrison (Former Verizon)	Townhomes	77 Units	Permitting / Site Prep	2027
Polaris at Eastgate	Multifamily	360 Units	Under Construction	2025

Nearby Office Developments



BELLEVUE 600

Amazon's major expansion in the Bellevue CBD. While downtown, its **massive scale (1.1M SF)** drives significant "overflow" demand into the Eastgate corridor for firms seeking lower-cost, high-image alternatives.



THE SPRING DISTRICT

While situated slightly north, this **36-acre neighborhood** is the primary driver of the Eastside's "Innovation Triangle," attracting tech giants and high-income professionals who utilize the I-90 corridor for transit.



THE ARTISE

Fully leased to Amazon, this **25-story trophy tower** represents a major expansion within the Bellevue CBD. With the shell and core complete, interior build-outs have resumed for a 2026 opening, signaling long-term tech commitment to the Eastside.

Bellevue 600	Office	1.1 Million SF	Under Construction	2025/2026
The Spring District	Mixed-Use	3.3 Million SF	Ongoing Phases	2024–2028
The Artise	Office	600,000 SF	Under Construction	2025

Regional Connectivity & Transit

EXISTING INFRASTRUCTURE

The property benefits from “unrivaled” regional access at the interchange of **I-90 and I-405**. It is walking distance to the **Eastgate Park & Ride**, one of the busiest transit hubs in King County, offering direct express bus service to Seattle and Issaquah every 10–15 minutes during peak hours.



FUTURE ISSAQUAH LINK (LINE 4)

As part of the Sound Transit 3 (ST3) expansion, the **Issaquah Link light rail** is in the planning phase. It will feature a dedicated **Eastgate Station** providing a direct high-capacity rail connection between Issaquah, Bellevue, and South Kirkland. This project will transform the corridor into a transit-oriented urban center over the coming decade.



The Talent Pipeline

The asset is surrounded by a “brain trust” of elite educational institutions that fuel the local workforce.



UNIVERSITY OF WA

- 63,700+ Total Students (52k+ at Seattle Campus)
- Top 10 Public University in the U.S.
- Global Leader in Medicine & Computer Science

Note: A primary engine for the region’s tech and research workforce.



BELLEVUE COLLEGE

- **Across I-90 from the Property**
- 20,000+ Total Annual Students
- #1 Community College in Washington

Note: Largest open-access college in the state; provides a direct pipeline of nursing, business, and tech talent to Eastgate.



BELLEVUE SCHOOL DISTRICT

- #1 School District in Washington (2024–2026)
- 92% Graduation Rate
- 10/10 Rating from GreatSchools

Note: Nearby Newport High is a nationally ranked STEM leader, drawing affluent professional families to the immediate area.

Regional Map & Drive Times

Centrally located between Seattle and Bellevue, the property offers fast access to major corporate hubs, top employers, and key regional destinations across the Eastside.

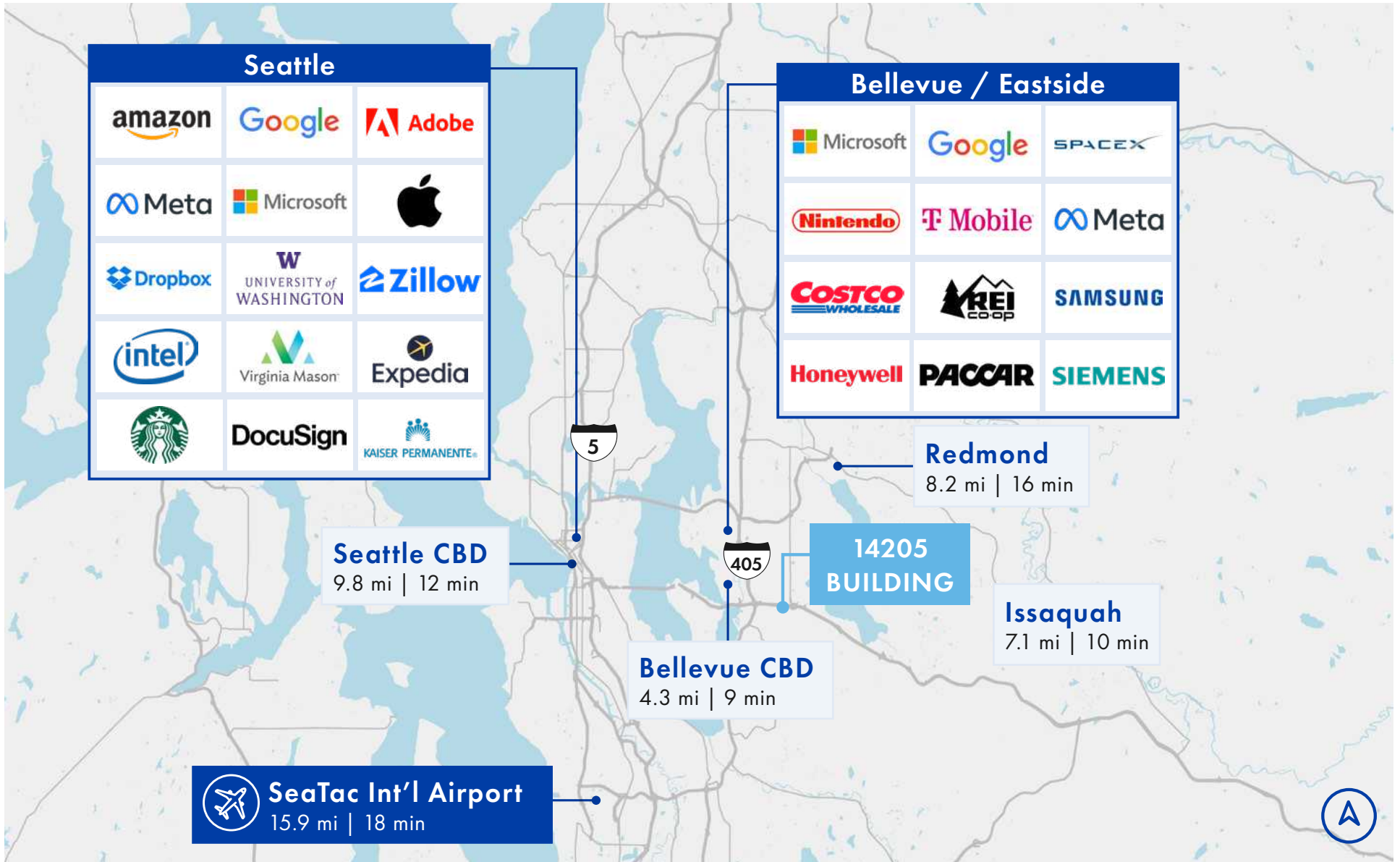

Local Demographics

Located in a premier 5-mile radius, the area features an average household income exceeding \$261,000. The dominant 25–54 age cohort ensures a high-growth, affluent consumer base.

POPULATION



AGE

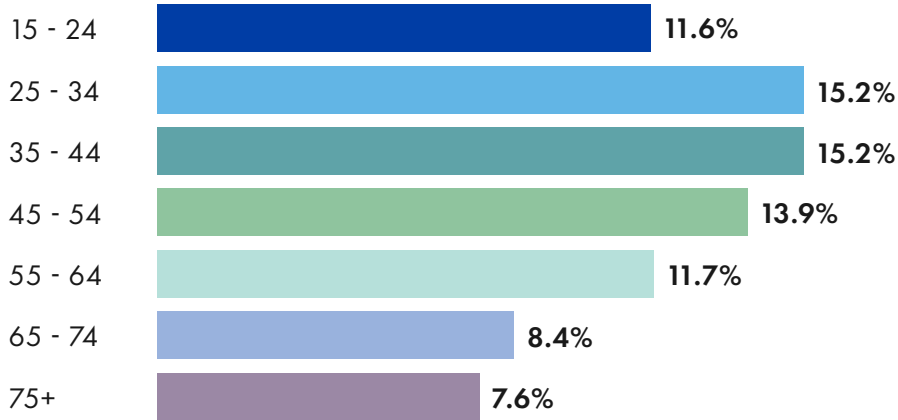

HOUSEHOLDS



INCOME BY HOUSEHOLD

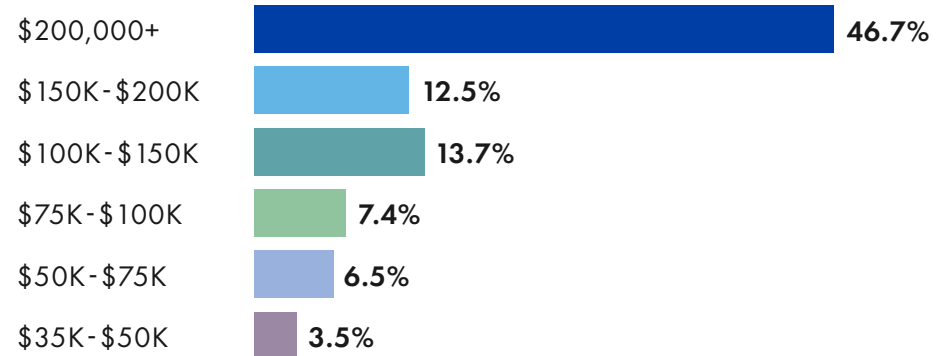

\$261,115
AVERAGE
HOUSEHOLD INCOME

\$183,993
MEDIAN
HOUSEHOLD INCOME

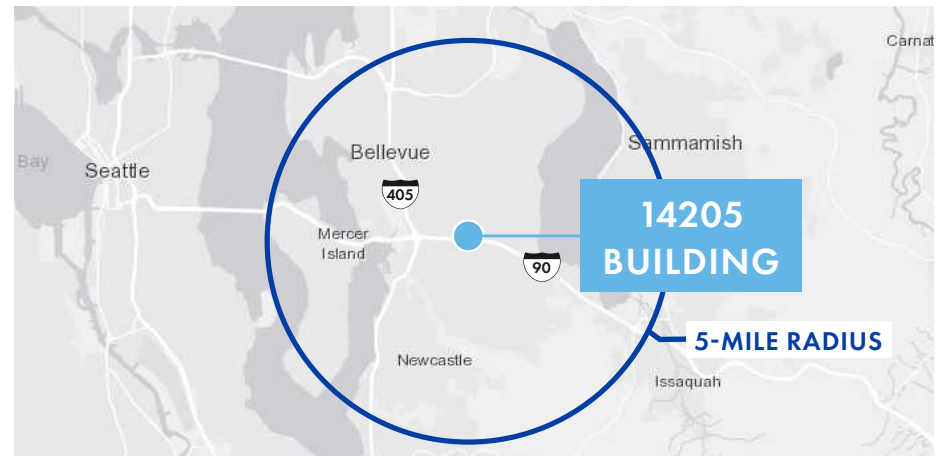

Seattle-Bellevue MSA

As a global epicenter for innovation, the region is anchored by corporate giants including Amazon, Microsoft, Google, and Meta. Bellevue has evolved into a premier destination for high-growth companies, attracting a sophisticated workforce and substantial private investment.

The area's economic resilience is driven by a diverse mix of cloud computing, aerospace, and biotechnology. With a skyline evolving through major developments and a massive "Big Tech" footprint, Bellevue remains a top-performing market for commercial real estate investment.

Metro Highlights

STRATEGIC ECONOMIC GROWTH



Driven by proactive infrastructure initiatives and continued Eastside expansion, the region is poised for long-term stability and transformative professional growth.

HIGHLY AFFLUENT DEMOGRAPHICS



The surrounding community features exceptional spending power, consistently scoring 200+ on spending potential indexes for dining, retail, and travel.

ELITE EDUCATION LEVELS

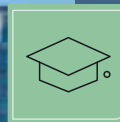

Approximately 75% of the population holds a Bachelor's degree or higher, offering employers direct access to one of the most qualified talent pools in the nation.

MEDIAN HH INCOME

\$183,993

Within
5-Mile Radius

ELITE EDUCATION

75.0%

Bachelor's Degree
or Higher

LOCAL STUDENT BASE

20,000+

Students at
Bellevue College

SPENDING POTENTIAL

200+

Consumer
Index Score

14205 BUILDING





Northmarq

OFFERED EXCLUSIVELY BY

RJ VARA

Senior Vice President
206.584.6195
rvara@northmarq.com
License: WA 135292

KEVIN ADATTO

License: WA 21038208

DEBT & EQUITY

STUART OSWALD

Managing Director
425.974.1005
soswald@northmarq.com

JACK BELL

Associate Producer
425.974.1058
jbell@northmarq.com

Northmarq

130 Nickerson St, Suite 200
Seattle, WA 98109

Commercial Real Estate

Debt + Equity | Investment Sales | Loan Servicing | Fund Management

northmarq.com

This Offering Memorandum has been prepared solely for informational purposes to assist prospective investors in evaluating a potential real estate investment opportunity. Northmarq makes no guarantees, representations, or warranties of any kind, expressed or implied, regarding the information including, but not limited to, warranties of content, completeness, accuracy, reliability, and fitness for any particular purpose. This document does not constitute an offer to sell or a solicitation of an offer to buy any securities, nor shall it be construed as investment, legal, or tax advice. Prospective investors are encouraged to conduct their own independent due diligence and consult with their financial, legal, and tax advisors before making any investment decisions. The projections, assumptions, and forward-looking statements included in this memorandum are for illustrative purposes only and are subject to significant uncertainties and risks. Actual results may differ materially from those expressed or implied. Past performance is not indicative of future results. By accepting this memorandum, the recipient agrees to keep its contents confidential and not to disclose or reproduce it, in whole or in part, without prior written consent. Neither the property owner nor any of its affiliates shall be liable for any loss or damage arising from reliance on the information contained herein. The use of any graphics or logos in this memorandum is for marketing purposes only, and does not in any way imply any ownership, use, or affiliation with the real estate that is the subject of this memorandum. ANY RELIANCE ON THE CONTENT OF THIS OFFERING MEMORANDUM IS SOLELY AT YOUR OWN RISK. © 2026. All rights reserved.