

FOR SALE

# SOUTH ADAMS INDUSTRIAL CAMPUS

4310-4320 S ADAMS ST, TACOMA, WA 98409

→ [VIEW PHOTOS](#)

*19,600 SF Two Building Campus*

SALE PRICE *\$3,600,000*



**PROPERTY OVERVIEW**

BUILDING SIZE	4310 S Adams 10,080 SF 4320 S Adams 9,520 SF
4310 OFFICE	1st Floor Office: 1,088 SF Mezz Office: 544 SF Mezz Storage: 816 SF
4320 OFFICE	1st Floor Office: 1,428 SF Mezz Office: 1,156 SF Mezz Storage Office: 272 SF
LAND	0.96 AC
TRUCK ACCESS	8 Grade-Level Doors
CLEAR HEIGHT	20'
JURISDICTION	City of Tacoma
ZONE	CIX-STGPD <a href="#">VIEW ZONING MAP</a>
APN	9360000020, 0220134020, 9325000100



# FLOOR PLAN

● Grade level loading

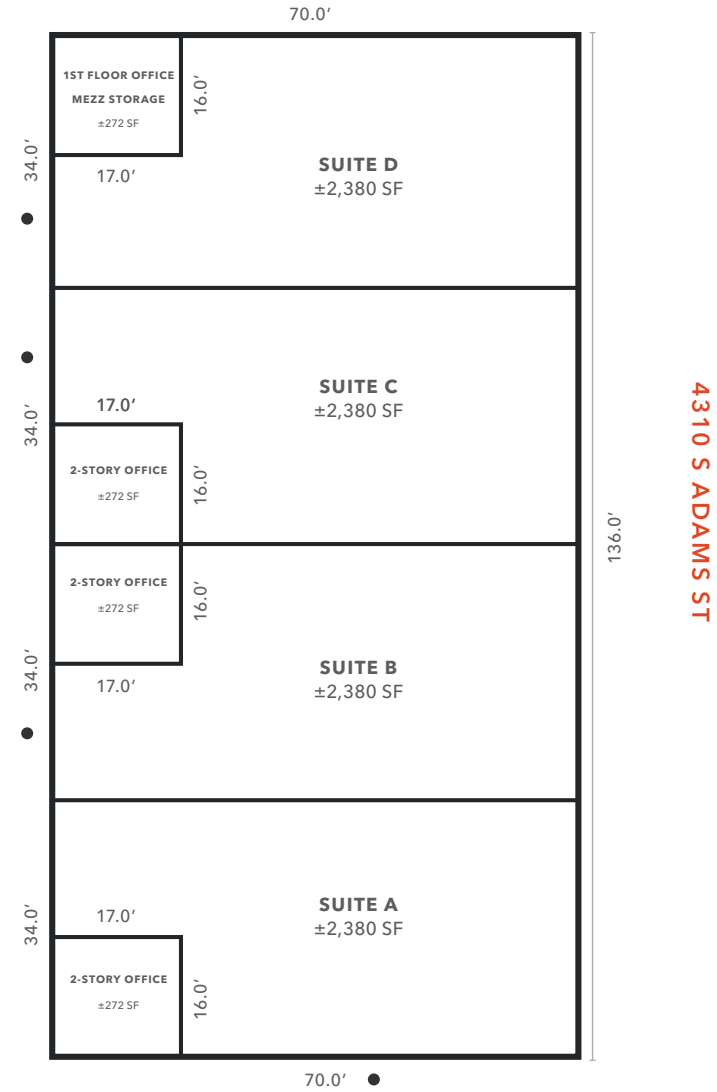
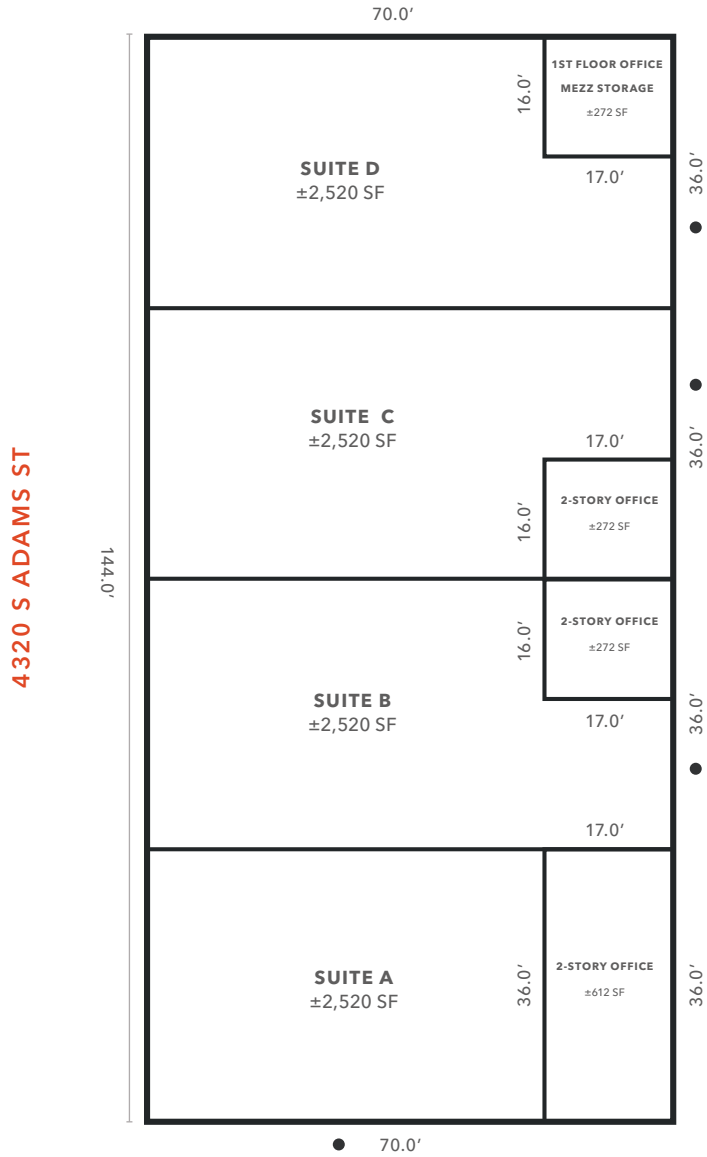

**RENT ROLL**

Building Address	Tenant Name	Suite #	SF	Lease Expiration	Current Base Rent	Base Rent PSF	Annual Base Rent	NNN Recapture (Annual)	Adjusted Base Rent Annual (NOI)	
4310 S ADAMS ST	Visual Options	B-D	7,000	2/28/2027	\$5,801.25	\$0.83	(\$15,493.14)	\$-	\$54,121.86	
4310 S ADAMS ST	Tenant B	A	2,520	6/30/2027	\$4,357.93	\$1.73	(\$5,164.38)	\$-	\$47,130.80	
4320 S ADAMS ST	Visual Options	A-D	10,080	2/28/2027	\$8,351.70	\$0.83	(\$21,872.66)	\$-	\$78,347.74	
4320 S ADAMS ST	N/A								\$-	
			<b>19,600</b>		<b>\$10,159.18</b>	<b>\$0.52</b>	<b>(\$20,657.51)</b>	<b>\$-</b>	<b>\$101,252.66</b>	
									<b>PURCHASE PRICE</b>	<b>\$3,600,000.00</b>
									<b>CAP RATE @ PURCHASE PRICE</b>	<b>2.81%</b>

**PROFORMA RENT ROLL**

Building Address	Suite #	SF	Base Rent PSF	Base Rent	Annual Base Rent	NNN Cost	NNN Recapture (Annual)	Adjusted Base Rent Annual (NOI)		
4310 S ADAMS ST	A	2,380	\$1.25	\$2,975.00	\$35,700.00	(\$5,164.38)	\$5,164.38	\$35,700.00		
4310 S ADAMS ST	B	2,380	\$1.25	\$2,975.00	\$35,700.00	(\$5,164.38)	\$5,164.38	\$35,700.00		
4310 S ADAMS ST	C	2,380	\$1.25	\$2,975.00	\$35,700.00	(\$5,164.38)	\$5,164.38	\$35,700.00		
4310 S ADAMS ST	D	2,380	\$1.25	\$2,975.00	\$35,700.00	(\$5,164.38)	\$5,164.38	\$35,700.00		
4320 S ADAMS ST	A	2,520	\$1.25	\$3,150.00	\$37,800.00	(\$5,468.17)	\$5,468.17	\$37,800.00		
4320 S ADAMS ST	B	2,520	\$1.25	\$3,150.00	\$37,800.00	(\$5,468.17)	\$5,468.17	\$37,800.00		
4320 S ADAMS ST	C	2,520	\$1.25	\$3,150.00	\$37,800.00	(\$5,468.17)	\$5,468.17	\$37,800.00		
4320 S ADAMS ST	D	2,520	\$1.25	\$3,150.00	\$37,800.00	(\$5,468.17)	\$5,468.17	\$37,800.00		
		<b>19,600</b>						<b>\$294,000.00</b>		
									<b>PURCHASE PRICE</b>	<b>\$3,600,000.00</b>
									<b>CAPITAL IMPROVEMENTS</b>	<b>\$291,000.00</b>
									<b>TOTAL ACQUISITION COST</b>	<b>\$3,891,000.00</b>
									<b>CAP RATE @ TOTAL BASIS</b>	<b>7.56%</b>

**CAPITAL IMPROVEMENTS BUDGET**

	Cost	\$/PSF
GENERAL BUILDING REPAIRS	\$196,000.00	\$10.00
LEASING COSTS	\$95,000.00	\$4.85
	<b>\$291,000.00</b>	<b>\$14.85</b>

SOUTH ADAMS INDUSTRIAL CAMPUS | 4310-4320 S ADAMS ST

*1.7 MI — 6 MINS*

TO I-5

*7 MI — 17 MINS*

TO PORT OF TACOMA

*5.4 MI — 10 MINS*

TO HWY 512

*12.0 MI — 17 MINS*

TO HWY 18

*22.8 MI — 31 MINS*

TO SEATAC

*36.4 MI — 51 MINS*

TO PORT OF SEATTLE

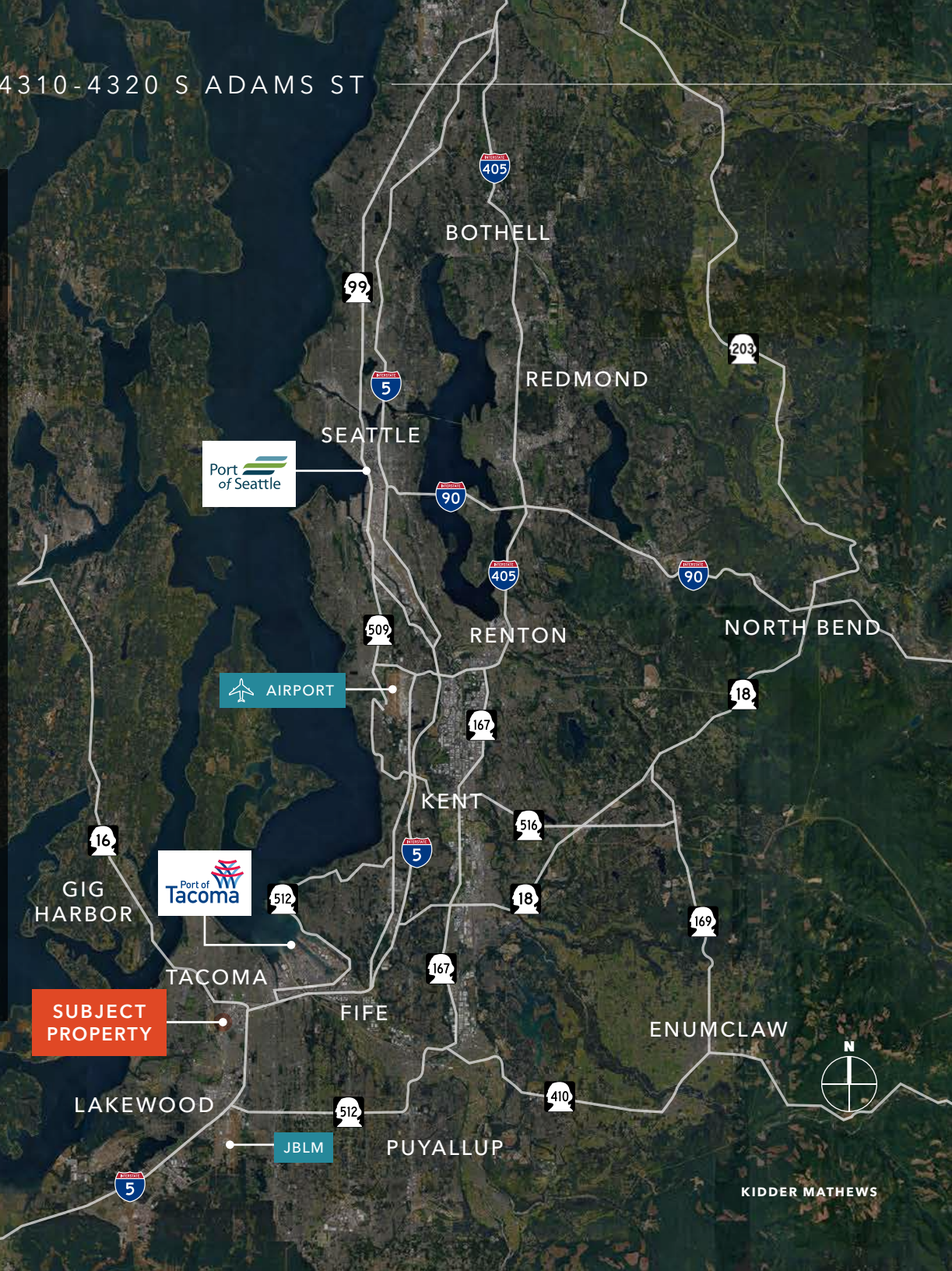

## SOUTH ADAMS INDUSTRIAL CAMPUS | 4310-4320 S ADAMS ST

South Adams Industrial Campus presents a rare opportunity to acquire a two-building industrial campus in Tacoma's established South End industrial corridor. Totalling 19,600 square feet across two freestanding buildings on nearly an acre of land, the property offers exceptional flexibility for owner-users or investors seeking functional, multi-tenant capable industrial space.

With 20-foot clear heights, eight grade-level doors, and CIX zoning, the campus is well-suited for a wide range of light industrial, distribution, and service-oriented uses. Strategically located in the City of Tacoma with convenient access to I-5, Highway 16, and the Port of Tacoma, this offering represents outstanding value in one of the South Sound's most active industrial markets.





APN 0220134020

APN 9325000100

APN 9360000020

# SOUTH ADAMS INDUSTRIAL CAMPUS | 4310-4320 S ADAMS ST

*For more information on this property, please contact*

**MATT MCLENNAN**, SIOR, CCIM  
Executive Vice President  
253.722.1458  
matt.mclennan@kidder.com

[KIDDER.COM](http://KIDDER.COM)

This information supplied herein is from sources we deem reliable. It is provided without any representation, warranty, or guarantee, expressed or implied as to its accuracy. Prospective Buyer or Tenant should conduct an independent investigation and verification of all matters deemed to be material, including, but not limited to, statements of income and expenses. Consult your attorney, accountant, or other professional advisor. All Kidder Mathews designs are the sole property of Kidder Mathews. Branded materials and layouts are not authorized for use by any other firm or person.

