

FOR SALE

BELLINGHAM INDUSTRIAL & EXCESS LAND

4350 PACIFIC HWY | BELLINGHAM, WA 98226



EXCLUSIVELY LEASED BY



KIDDER.COM

BELLINGHAM INDUSTRIAL & EXCESS LAND

PROPERTY HIGHLIGHTS

TOTAL LAND AREA	8.26 AC (6.83 AC Usable)
TOTAL BUILDING SF	30,000 SF
GROSS LEASABLE SF	33,330 SF (Including Mezz)
OFFICE SF	3,330 SF
MEZZANINE SF	3,330 SF
DOCK DOORS	5 - 29" Bays; 1 - 48" Bay
DRIVE IN DOORS	1 - 12'x16'
CLEAR HEIGHT	28' - 33'
COLUMN SPACING	25'
PARKING	±19 Spaces
ZONING	I-Industrial
SIGNAGE	Pylon Sign with Digital Display
SALE PRICE	\$4,900,000

\$4.9M

SALE PRICE

33K SF

AVAILABLE



FLOOR PLAN

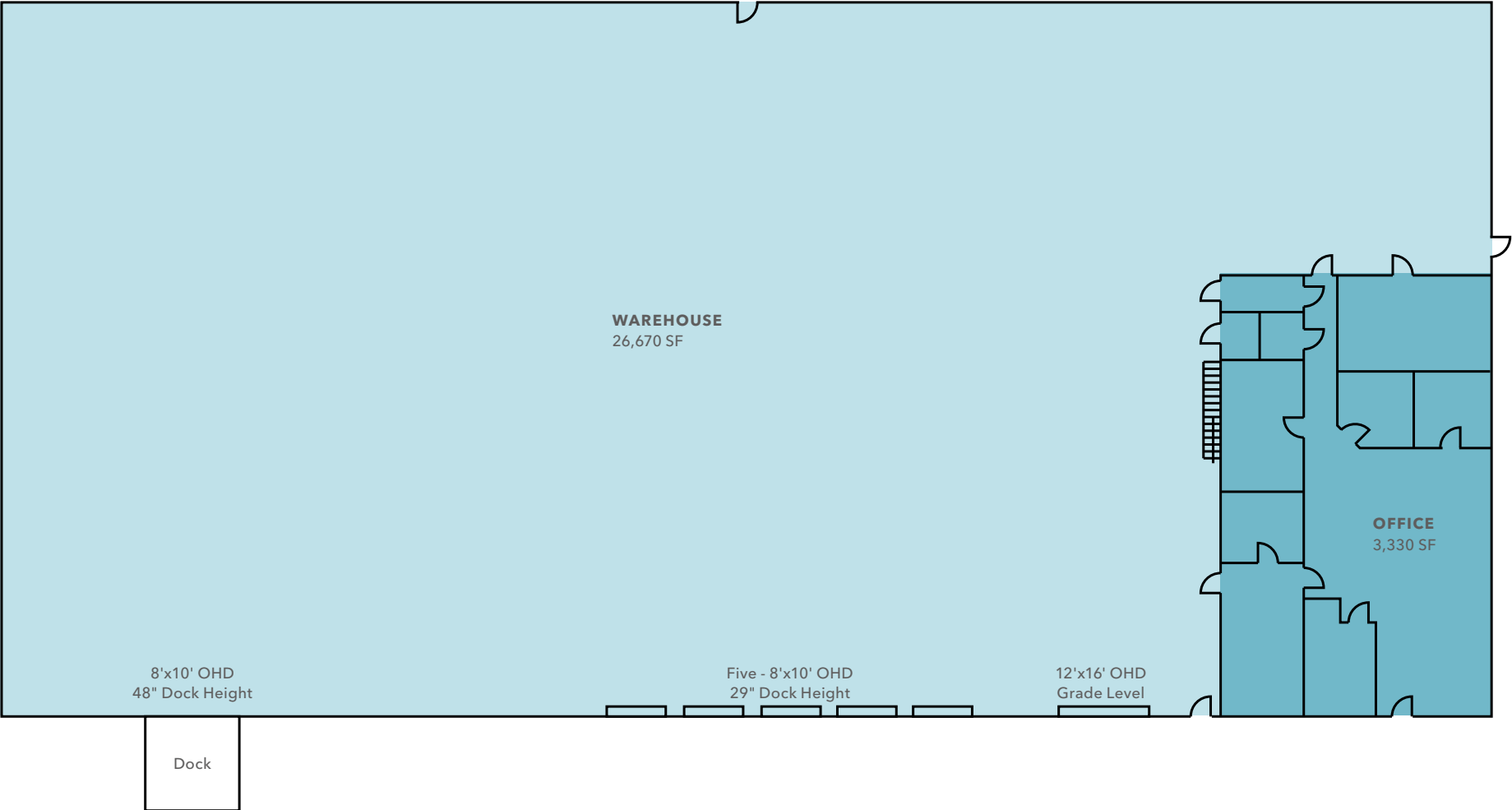

km Kidder Mathews

REMAX WHATCOM COUNTY

SUBJECT PROPERTY

PACIFIC STORAGE COMPANY

Holiday Inn

COSTCO WHOLESALE

LAQUINTA INNS & SUITES

Whatcom COMMUNITY COLLEGE

Walmart

Olive Garden ITALIAN KITCHEN

BELLINGHAM AIRPORT

Best Western

Starbucks

Jack in the box

Walgreens

ROSS DRESS FOR LESS

Shari's

Fred Meyer

HOME 2 EDITED BY HILSON

SPRINGHILL SUITES Marriott

Guitar Center

DOLLAR TREE

MERIDIAN VILLAGE

BELLIS FAIR

PANDA EXPRESS CHINESE RESTAURANT

AMERICAN EAGLE

ASHLEY

Ben Bridge

Target

BUFFALO WILD WINGS GRILL & BAR

CAI POPE RESTAURANT

H&M

SUBWAY

JCPenney

macy's

OLD NAVY

THE HOME DEPOT

Public Storage



Exclusively listed by

ERIK SWANSON
Kidder Mathews
206.296.9628
erik.swanson@kidder.com

MIKE KING, CCIM
Kidder Mathews
206.926.9292
mike.king@kidder.com

KEITH COOK
RE/MAX Whatcom County
360.739.5600
keith@buyermax.com

KIDDER.COM

This information supplied herein is from sources we deem reliable. It is provided without any representation, warranty, or guarantee, expressed or implied as to its accuracy. Prospective Buyer or Tenant should conduct an independent investigation and verification of all matters deemed to be material, including, but not limited to, statements of income and expenses. Consult your attorney, accountant, or other professional advisor. All Kidder Mathews designs are the sole property of Kidder Mathews. Branded materials and layouts are not authorized for use by any other firm or person.