

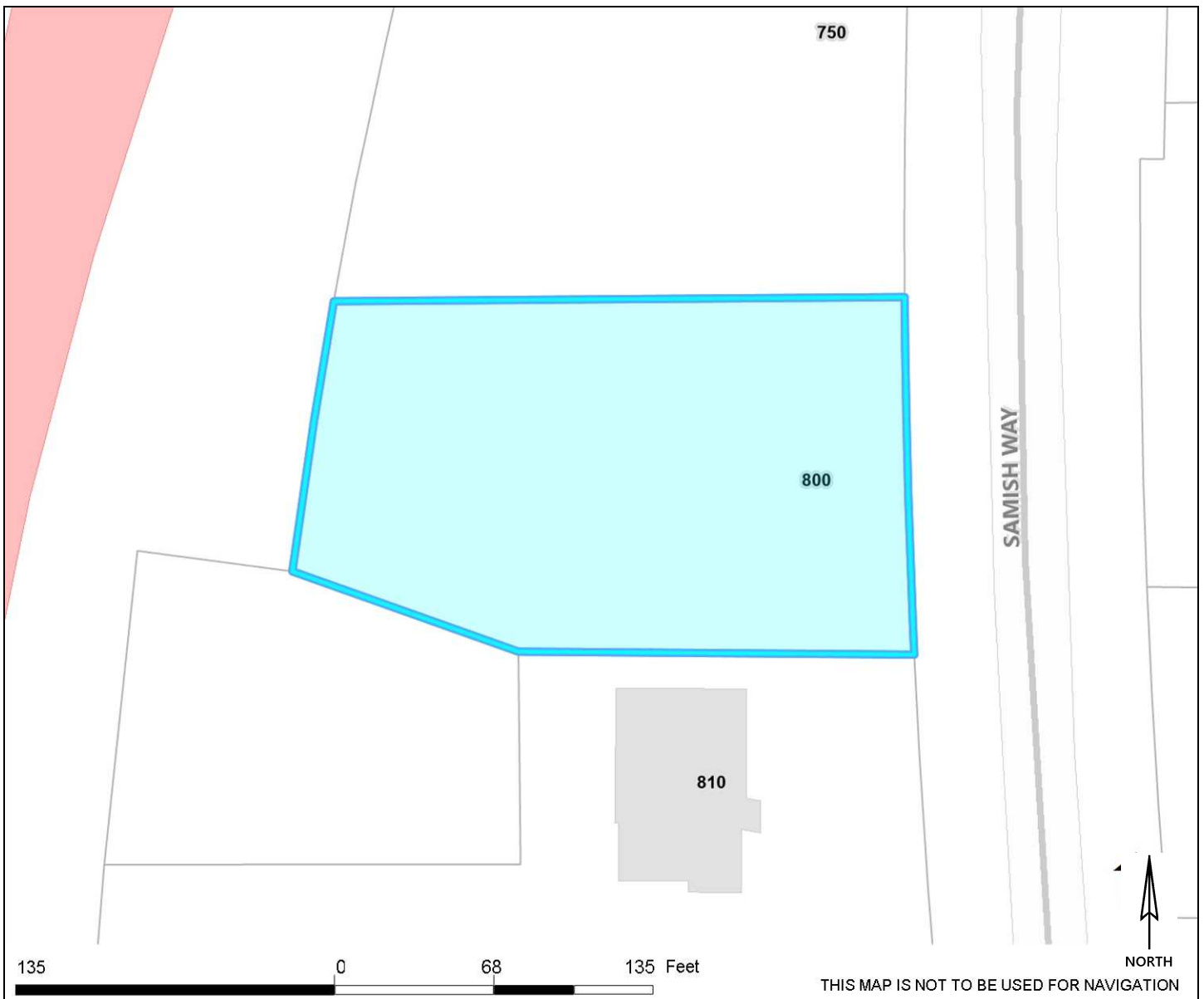

Land Parcel Report for 370306371353

for site address of 800 SAMISH WAY



Assessor Property Info

Appraised Property Value

Property ID: 183225
 Assessor address: 800 SAMISH WAY
 Owner name: KEITH A & BARBARA TROSKE
 50% &
 Land use: COMMERCIAL

Land value: \$713,505
 Improvement value: \$0
 Total value: \$713,505

Legal Description

Contact the Whatcom County Assessors office (360-778-5050) for the complete legal description.

LOT B SAMISH VIEW LLA AS REC AF 2016-1203452

Full Parcel Number(s)

[3703063713530000](#)

Site Address(es)

800 SAMISH WAY

Parcel Area

Mapped parcel area (sq ft): 36547
Mapped parcel area (acres): 0.84
Assessor legal acreage: 0.84

Neighborhood

[SAMISH](#)

Zoning

COMMERCIAL Subarea: 9
RESIDENTIAL SINGLE Subarea: 4
[Neighborhood Zoning](#)

Historical Information

(Not available)

Zoning (Urban Village)

(Not available)

Watershed

Padden Creek, Sub Basin: Connelly Creek

Survey Records

| Recorded date | Survey firm / Description | Documents |
|---------------|---|---------------------------|
| 09/10/2021 | CITY OF BELLINGHAM/SURVEY 2021 MONUMENTS REPLACED BY COB | More info |

Survey Records

| Recorded date | Survey firm / Description | Documents |
|---------------|--|---------------------------|
| 10/17/2007 | CITY OF BELLINGHAM 2005 HORIZONTAL CONTROL NETWORK. SURVEY TO ESTABLISH LOCAL CONTROL POINTS TO EXTEND THE NATIONAL GEODETIC SURVEY (NGS) HORIZONTAL CONTROL NETWORK WITHIN THE BELLINGHAM AREA IN NAD83/98 WASHINGTON STATE PLANE, NORTH ZONE, U.S. SURVEY FEET DATUM. SEE AFFIDAVIT OF CORRECTION AF2090401447 | More info |
| 10/17/2007 | CITY OF BELLINGHAM 2005 HORIZONTAL CONTROL NETWORK. SURVEY TO ESTABLISH LOCAL CONTROL POINTS TO EXTEND THE NATIONAL GEODETIC SURVEY (NGS) HORIZONTAL CONTROL NETWORK WITHIN THE BELLINGHAM AREA IN NAD83/98 WASHINGTON STATE PLANE, NORTH ZONE, U.S. SURVEY FEET DATUM. SEE AFFIDAVIT OF CORRECTION AF2090401447 | More info |
| 06/10/1992 | CHRISTENSON ENGINEERING CORP. SW 1/4, NE 1/4, SEC 6. CITY JOB NO DR304. SAMISH STORM. | More info |
| 03/13/1992 | CHRISTENSON ENGINEERING CORP. NE 1/4 & E 1/2 OF THE SE 1/4 SEC. 6 & E 1/2 NE 1/4 SEC 7; SAMISH WAY FROM RIDGEMONT WAY TO SOUTH AVE.; TAYLOR AVE., 36TH ST., MILL AVE., LARRABEE AVE., DONOVAN AVE., WILSON AVE., COWGILL AVE., JULIA AVE., LINDSAY AVE., 37TH ST., 38TH ST., CONNELLY AVE., | More info |
| 09/11/1974 | JAMES E. WILSON & ASSOCIATES CITY CADASTRAL MAP | More info |
| 10/31/1973 | CONSTRUCTION SURVEYORS N W INC. SURVEY OF PARCELS BETWEEN SAMISH WAY AND I-5. BETWEEN ADAMS & TAYLOR | More info |
| 06/12/1956 | STATE OF WASHINGTON WSDOT SURVEY FOR I-5 NEAR SAMISH WAY | More info |
| 11/22/1934 | NE 1/4 OF SEC. 31; ELLIS ST., LAKE ST., JERSEY ST., HOLLY ST.; | More info |

Subdivisions

| Status | Name | Documents |
|------------|------------------------------------|---------------------------|
| CURRENT | SAMISH VIEW LLLA | More info |
| CURRENT | SAMISH WAY | More info |
| HISTORICAL | KELLOGG'S GARDEN TRACTS, FAIRHAVEN | More info |

Subdivisions

| Status | Name | Documents |
|------------|-------------|---------------------------|
| HISTORICAL | SAMISH VIEW | More info |

Permits

| Permit Number | Permit Type | Permit Subtype | Status | Finalized Date |
|---------------|----------------------------------|---------------------------------|---------------------|----------------|
| BLD2021-0226 | BUILDING MULTIFAMILY RESIDENTIAL | NEW CONSTRUCTION | RTI HOLD | |
| BLD2021-0229 | MISCELLANEOUS STRUCTURE | OTHER | VOIDED OR WITHDRAWN | |
| BLD2021-0237 | BUILDING MULTIFAMILY RESIDENTIAL | UNDERGROUND STORMWATER FACILITY | RTI HOLD | |
| MEC2024-0017 | MECHANICAL | NEW OR ALTERED SYSTEMS | RTI HOLD | |
| PBW2022-0197 | UTILITIES FRANCHISE | | ISSUED | |
| PLM2024-0014 | PLUMBING NONRESIDENTIAL | NEW FIXTURES | RTI HOLD | |

Projects - Land Use and Environmental

| Project Number | Project Type / Description | Project Subtype | Status | Approved Date |
|----------------|---|-----------------|----------|---------------|
| DR2020-0030 | DESIGN REVIEW SEE PDP2020-0006 , 2 MULTIFAM. BLDS - 750-800 SAMISH | MULTIFAMILY | APPROVED | 09/11/2024 |

DISCLAIMER: The City of Bellingham has compiled this information for its own use and is not responsible for any use of this information by others. The information found herein is provided simply as a courtesy to the public and is not intended for any third party use in any official, professional or other authoritative capacity. Persons using this information do so at their own risk and by such use agree to defend, indemnify and hold harmless the City of Bellingham as to any claims, damages, liability, losses or suits arising out of such use.

[Visit the City of Bellingham's Policies and Disclaimers web page for additional information at https://cob.org/about/policies.](https://cob.org/about/policies)

[Contact Whatcom County Assessors office for most recent parcel information. Phone: \(360-778-5050\) Web: http://www.co.whatcom.wa.us/assessor/](http://www.co.whatcom.wa.us/assessor/)